

ADJUSTABLE ALUMINIUM CHANNEL (A30036) - TOP MOUNT

Step 1. Drill screw holes on the ground

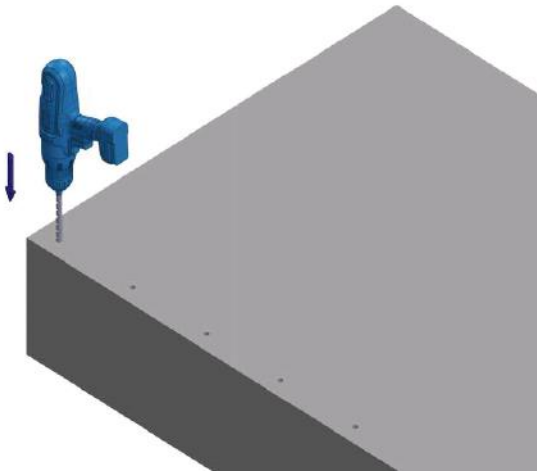

Step 2. Place the aluminium channel to position, and install it with anchor bolts.

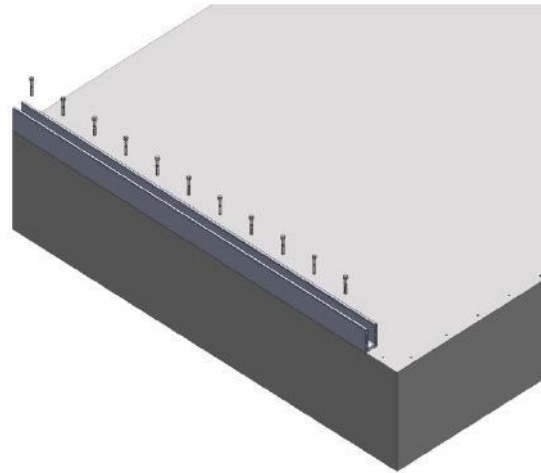

Step 3. Use connector pins between two lengths of aluminium channels, or connect the channel to a 90 degree corner.

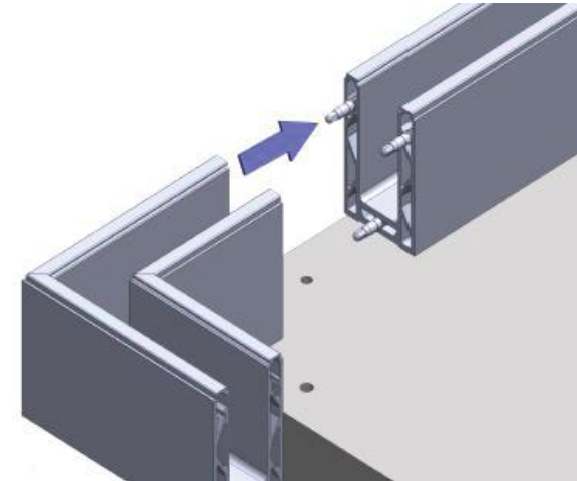

Step 4. Place the adjustable wedges into the channel

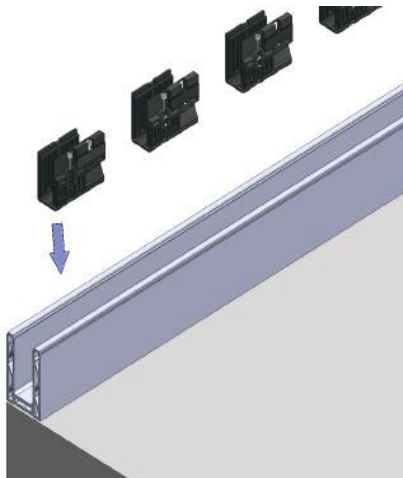

Step 5. Click on the front-side top bead (with rubber gasket)

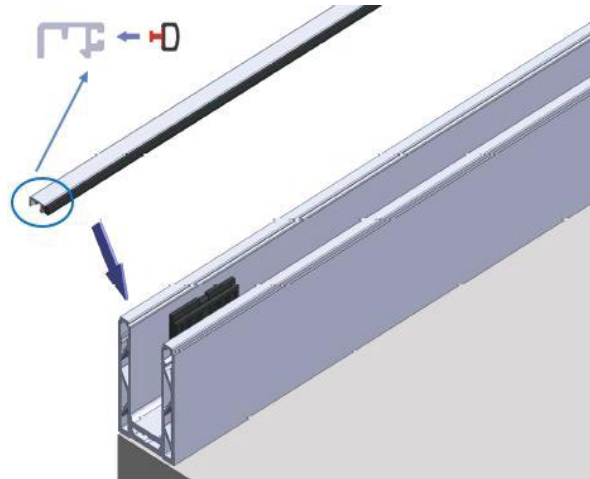

Step 6. Place glass channel into the channel and adjust the alignment between glass panels

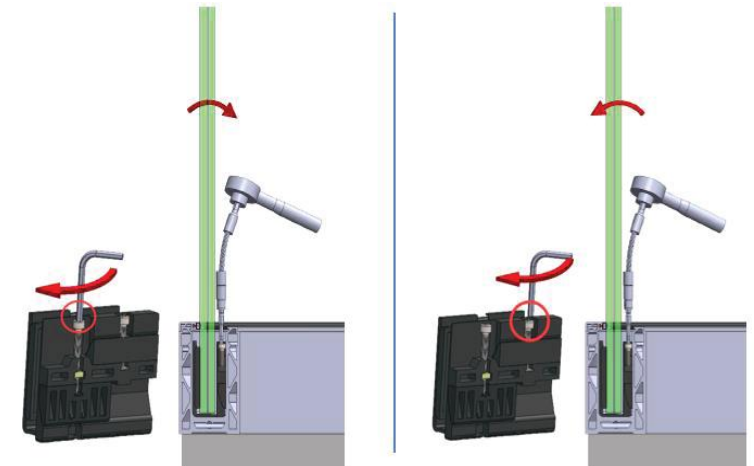

ADJUSTABLE ALUMINIUM CHANNEL (A30036) - TOP MOUNT

Step 7. Click on the back-side top bead (with rubber gasket)

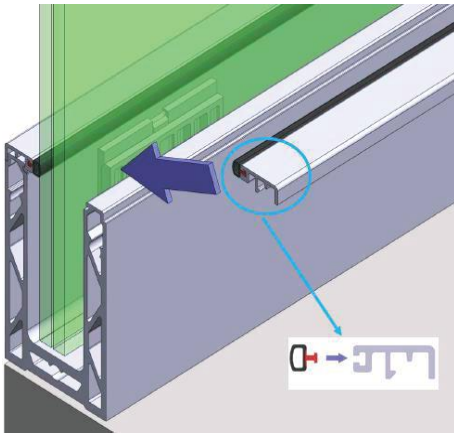

Step 8. Stick the end cap to the aluminum channel with double-sided tape

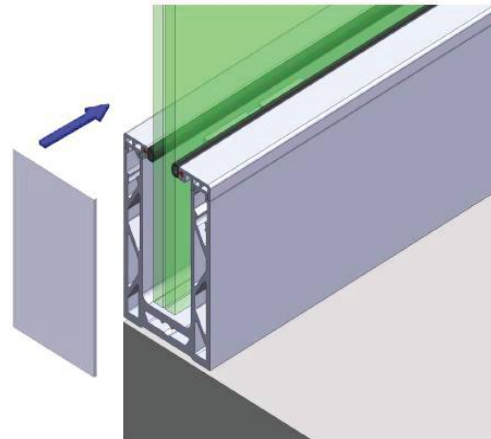

Step 9 (Optional). Aluminium cap rail available

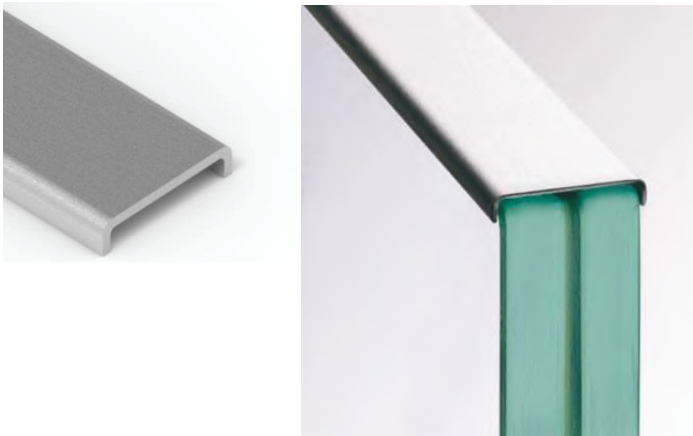

Fast installation
Easy alignment
Stylish look
Satin anodized finish
Powder coated coloured finishes

