

FSA 120.0 R

**STIHL**



2 - 26      Instruction Manual



## Contents

1	Introduction.....	2
2	Guide to Using this Manual.....	2
3	Overview.....	3
4	Safety Precautions.....	4
5	Preparing Trimmer for Operation.....	10
6	Charging the Battery, LEDs.....	11
7	Activating and Deactivating Bluetooth® Radio Interface.....	11
8	Assembling the Trimmer.....	11
9	Adjusting Trimmer for User.....	14
10	Removing and Fitting the Battery.....	15
11	Switching the Trimmer On/Off.....	15
12	Testing the Trimmer and Battery.....	15
13	Operating the Trimmer.....	16
14	After Finishing Work.....	17
15	Transporting.....	17
16	Storing.....	18
17	Cleaning.....	18
18	Maintenance.....	18
19	Repairing.....	18
20	Troubleshooting.....	19
21	Specifications.....	20
22	Combinations of Cutting Attachments, Deflectors and Carrying Systems.....	21
23	Spare Parts and Accessories.....	22
24	Disposal.....	22
25	EC Declaration of Conformity.....	22
26	UKCA Declaration of Conformity.....	22
27	General Power Tool Safety Warnings.....	23

## 1 Introduction

Dear Customer,

Thank you for choosing STIHL. We develop and manufacture our quality products to meet our customers' requirements. The products are designed for reliability even under extreme conditions.

STIHL also stands for premium service quality. Our dealers guarantee competent advice and instruction as well as comprehensive service support.

STIHL expressly commit themselves to a sustainable and responsible handling of natural resources. This user manual is intended to help you use your STIHL product safely and in an environmentally friendly manner over a long service life.

We thank you for your confidence in us and hope you will enjoy working with your STIHL product.



Dr. Nikolas Stihl

**IMPORTANT! READ BEFORE USING AND  
KEEP IN A SAFE PLACE FOR REFERENCE.**

## 2 Guide to Using this Manual

### 2.1 Applicable documents

The local safety regulations apply.

- ▶ In addition to this User Manual, you should also read, understand and retain the following documents:
  - User Manual and packaging of the cutting attachment being used
  - User manual of the carrying system you are using
  - User Manual for STIHL AR battery
  - User Manual for "AP belt bag with connecting cable"
  - Safety notices and precautions for STIHL AP battery
  - User Manual for STIHL AL 101, 301, 301-4, 500 chargers
  - Safety information for STIHL batteries and products with built-in battery:  
[www.stihl.com/safety-data-sheets](http://www.stihl.com/safety-data-sheets)

For further information on STIHL connected, compatible products and FAQs, please visit [www.connect.stihl.com](http://www.connect.stihl.com) or available from a STIHL servicing dealer.

The Bluetooth® word mark and logos are registered trademarks owned by Bluetooth SIG, Inc. These word marks and logos are used by STIHL under license.

Batteries with  are equipped with a Bluetooth® radio interface. Local operating restrictions (in aircraft or hospitals, for example) must be observed.

### 2.2 Symbols used with warnings in the text



- This symbol indicates dangers that can cause serious injuries or death.
  - ▶ The measures indicated can avoid serious injuries or death.

**NOTICE**

- This symbol indicates dangers that can cause damage to property.
  - ▶ The measures indicated can avoid damage to property.

**2.3 Symbols in Text**

This symbol refers to a chapter in this instruction manual.

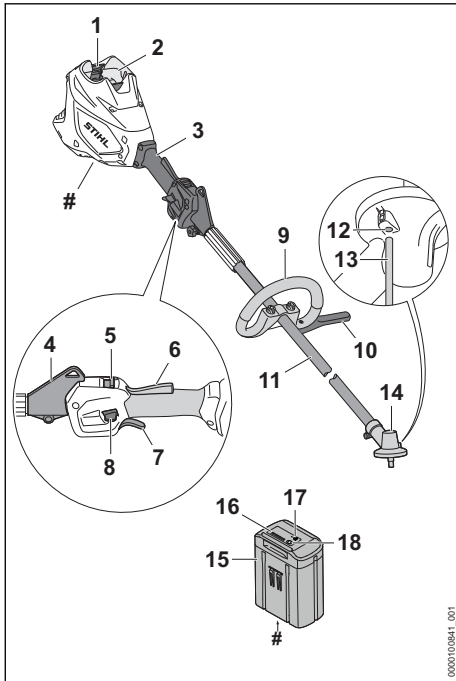
**3 Overview****3.1 Brushcutter and Battery****1 Battery compartment**

The battery compartment holds the battery.

**2 Locking lever**

The locking lever holds the battery in the battery compartment.

**3 Control handle**

The control handle is used for operating, holding and controlling the brushcutter.

**4 Carrying ring**

The carrying ring is for attaching the carrying system.

**5 Power setting switch**

The power setting switch is used to select the power level.

**6 Ergo lever**

The Ergo lever holds the release slide in position when the trigger is released.

**7 Trigger**

The trigger switches the brushcutter on and off.

**8 Release slide**

The release slide releases the trigger.

**9 Loop handle**

For holding and controlling the brushcutter.

**10 Bump guard**

The bump guard protect objects from contact with the cutting attachment.

**11 Shaft**

The shaft connects all components.

**12 Opening for stop pin**

The opening for the stop pin accommodates the stop pin.

**13 Stop pin**

The stop pin blocks the shaft while a cutting attachment is being mounted.

**14 Gear housing**

The gear housing encloses the gearbox.

**15 Battery**

The battery supplies power to the brushcutter.

**16 LEDs**

The LEDs indicate the state of charge of the battery and any faults.

**17 Pushbutton**

The pushbutton activates the LEDs on the battery. The pushbutton activates and deactivates Bluetooth® radio interface (if available).

**18 "BLUETOOTH" LED (only for batteries with**

The LED indicates the activation and deactivation of the Bluetooth® interface.

**# Rating plate with the machine number****3.2 Deflectors and Cutting Attachments**

The illustrations show examples of deflectors and cutting attachments. Approved combinations are listed in this instruction manual, 22.1.

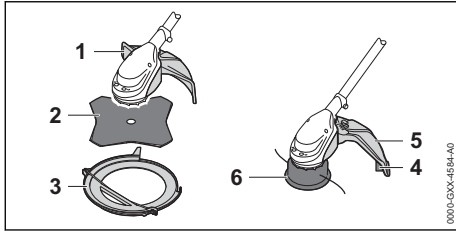

- 1 Deflector for metal cutting attachments**  
The metal cutting tool guard protects the user from thrown objects and contact with the grass cutting blade or brush knife.
- 2 Grass Cutting Blade**  
Cuts grass and weeds.
- 3 Transport guard**  
Helps protect user from contact with metal cutting attachments.
- 4 Line limiting blade**  
Line limiting blade trims nylon lines to correct length.
- 5 Deflector for mowing heads**  
Protects user from flying debris and contact with the mowing head.
- 6 Mowing head**  
Mowing head accommodates the mowing lines.

### 3.3 Symbols

Meanings of symbols that may be on the brushcutter, deflector and battery:



1 LED lights up red. The battery is too warm or too cold.



4 LEDs flash red. There is a fault in the battery.



This symbol indicates the direction of rotation of the cutting attachment.

max Ø XXX This symbol shows the maximum diameter of the cutting attachment in millimeters.



This symbol shows the maximum speed of the cutting attachment.



Guaranteed sound power level in accordance with Directive 2000/14/EC in dB(A) for the purpose of comparing the sound emissions of products.



The battery is equipped with a Bluetooth® interface and can be paired with the STIHL connected app.



The information next to the symbol indicates the energy content of the battery according to the cell manufacturer's specification. The energy content available in operation is lower.



Do not dispose of the product with domestic waste.



Maximum power level.



ECO power level.

## 4 Safety Precautions

### 4.1 Warning Signs

#### 4.1.1 Warning Symbols

Meanings of warning signs and labels on the brushcutter, battery and charger:



Observe safety warnings and take the necessary precautions.



Read and understand the user manual and keep it in a safe place for reference.



Wear protective glasses.  
If objects are likely to fall while working: wear a hard hat.



Wear safety boots.



Wear work gloves.



Observe the safety information on kickback and take the necessary precautions.



Comply with the safety instructions concerning ejected objects and take the necessary precautions.



Maintain a safe distance.



Remove the battery during work interruptions, transport, storage, maintenance or repair.



Protect the battery against heat and fire.



Do not immerse the battery in liquids.

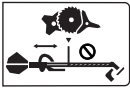

Respect the required minimum distance between the loop handle and the cutting attachment.

#### 4.1.2 Deflector for mowing heads

Meanings of warning signs and labels on the deflector for mowing heads:



Use this deflector for mowing heads.



Do not use this deflector for grass cutting blades.

### 4.2 Intended Use

The STIHL FSA 120.0 R brushcutter is designed for the following applications:

- With a mowing head: mowing grass
- With a grass cutting blade: mowing grass and weeds

The brushcutter may be used in the rain.

The brushcutter is powered by a STIHL AP battery or a STIHL AR battery.

The battery with  in combination with the STIHL connected app enables customization and the transfer of information to the battery using Bluetooth® technology.

### ▲ WARNING

- Batteries not explicitly approved for the brushcutter by STIHL may cause a fire or an explosion. Persons may be seriously or fatally injured, and property may be damaged.
  - ▶ Use the brushcutter with a STIHL AP battery or a STIHL AR battery.
- Using the brushcutter or the battery for purposes for which they were not designed may result in serious or fatal injuries and damage to property.
  - ▶ Use the brushcutter as described in this user manual.
  - ▶ Use the battery as described in this user manual, the STIHL AR battery user manual,

the STIHL connected app and at [www.connect.stihl.com](http://www.connect.stihl.com).

### 4.3 The Operator

#### ▲ WARNING

- Users without adequate training or instruction cannot recognize or assess the risks involved in using the trimmer and battery. The user or other persons may sustain serious or fatal injuries.



▶ Read, understand and save the instruction manual.

- ▶ If the trimmer or battery are passed on to another person: Always give them the instruction manual.
- ▶ Make sure the user meets the following requirements:
  - The user must be rested.
  - The user must be in good physical condition and mental health to operate and work with the trimmer and battery. If the user's physical, sensory or mental ability is restricted, he or she may work only under the supervision of or as instructed by a responsible person.
  - The user is able to recognize and assess the risks involved in using the trimmer and battery.
  - The user must be of legal age or is being trained in a trade under supervision in accordance with national rules and regulations.
  - The user has received instruction from a STIHL servicing dealer or other experienced user before working with the trimmer for the first time.
  - The user must not be under the influence of alcohol, medication or drugs.
- ▶ If you have any queries: Contact a STIHL servicing dealer for assistance.

### 4.4 Clothing and equipment

#### ▲ WARNING

- Long hair can be drawn into the brushcutter during operation. This may result in serious injury to the user.
  - ▶ Tie up and confine long hair above your shoulders.
- Objects can be thrown at high speed during operation. This may result in injury to the user.



- ▶ Wear close-fitting safety glasses. Suitable safety glasses are tested in accordance with EN 166 or national regulations and available commercially with the corresponding marking.

- ▶ Wear face protection.
- ▶ Wear long trousers made from resistant material.
- Falling objects can cause head injuries.



- ▶ If objects are likely to fall while working: wear a hard hat

- Dust can be whipped up during operation. Whipped up dust can damage the respiratory passages and cause allergic reactions.
  - ▶ If dust is generated: Wear a dust respirator mask.
- Inappropriate clothing can snag on wood, brush or the brushcutter. Users not wearing suitable clothing are at risk of serious injury.
  - ▶ Wear close-fitting clothing.
  - ▶ Remove scarves and jewelry.
- The user may come into contact with the rotating cutting attachment during operation. This may result in serious injury to the user.
  - ▶ Wear robust footwear.



- ▶ If you are using a metal cutting attachment: Wear steel-toed safety boots.

- ▶ Wear long trousers made from resistant material.
- There is a risk of the user coming into contact with the cutting attachment or the line limiting blade during cleaning and maintenance work and when the cutting attachment is mounted or removed. This may result in injury to the user.



- ▶ Wear work gloves made from resistant material.

- Wearing unsuitable footwear may cause the user to slip. This may result in injury to the user.
  - ▶ Wear sturdy, closed-toed footwear with high-grip soles.

## 4.5 Work Area and Surroundings

### 4.5.1 Brushcutter

#### ▲ WARNING

- Bystanders, children and animals are not aware of the dangers of the brushcutter or flying debris. This may result in serious injury to

bystanders, children and animals and damage to property.



- ▶ Do not allow bystanders, children or animals within 15 meters of the work area.

- ▶ Maintain a clearance of 15 meters from objects.
- ▶ Do not leave the brushcutter unattended.
- ▶ Make sure that children cannot play with the brushcutter.
- Electrical components of the brushcutter can produce sparks. Sparks may cause fires and explosions in highly flammable or explosive environments. Persons may be seriously or fatally injured and property may be damaged.
  - ▶ Do not work in a highly flammable or explosive environment.

### 4.5.2 Battery

#### ▲ WARNING

- Bystanders, children and animals cannot recognize or assess the dangers of the battery. Bystanders, children and animals may be seriously injured.
  - ▶ Keep bystanders, children and animals away from the work area.
  - ▶ Do not leave the battery unattended.
  - ▶ Make sure that children cannot play with the battery.
- The battery is not protected against all ambient conditions. If the battery is exposed to certain ambient conditions, the battery may catch fire, explode or be irreparably damaged. This may result in serious injury to people and damage to property.



- ▶ Protect battery from heat and fire.
- ▶ Do not throw the battery into a fire.

- ▶ Do not charge, use and store the battery outside of the specified temperature limits, 21.3.



- ▶ Do not immerse the battery in liquids.

- ▶ Keep battery away from small metal parts.
- ▶ Do not expose the battery to high pressure.
- ▶ Do not expose the battery to microwaves.
- ▶ Protect the battery from chemicals and salts.

## 4.6 Safe Condition

### 4.6.1 Brushcutter

The brushcutter is in a safe condition if the following points are observed:

- The brushcutter is not damaged.
- The brushcutter is clean.
- The controls function properly and have not been modified.
- A combination of cutting attachment and deflector recommended in this user manual is mounted.
- The cutting attachment and deflector are properly mounted.
- Genuine STIHL accessories for this brushcutter are fitted.
- The accessories are correctly attached.

### ▲ WARNING

- If not in safe condition, components may no longer operate correctly and safety devices may be disabled. This may result in serious or fatal injury to people.
  - ▶ Work only with an undamaged brushcutter.
  - ▶ If the brushcutter is dirty: Clean the brushcutter.
  - ▶ Never attempt to modify your brushcutter. Exception: Mounting one of the combinations of cutting attachment and deflector recommended in this user manual.
  - ▶ If the controls do not function properly: Do not use your brushcutter.
  - ▶ Fit genuine STIHL accessories for this brushcutter.
  - ▶ Mount the cutting attachment and deflector as described in this user manual.
  - ▶ Attach accessories as described in this User Manual or in the User Manual for the accessories.
  - ▶ Never insert objects in the openings of the brushcutter.
  - ▶ Replace worn or damaged labels.
  - ▶ If you have any doubts, be sure to consult a STIHL dealer.

### 4.6.2 Deflector

The deflector is in a safe condition if the following points are observed:

- The deflector is not damaged.
- If you are using the line limiting blade and skirt: Line limiting blade and skirt are correctly fitted.

### ▲ WARNING

- If components do not comply with safety requirements, they will no longer function

properly and safety devices may be rendered inoperative. This can result in serious injuries.

- ▶ Work only with an undamaged deflector.
- ▶ If you are using the line limiting blade and skirt: Work with a correctly fitted line limiting blade and skirt.
- ▶ If you have any queries: Contact your STIHL servicing dealer.

### 4.6.3 Mowing Head

The mowing head is in a safe condition if the following points are observed:

- The mowing head is not damaged.
- The mowing head is not jammed.
- The mowing head is correctly installed and firmly tightened.
- The mowing lines are properly installed.
- The wear limits are not exceeded.

### ▲ WARNING

- If they are in an unsafe condition, parts of the mowing head or mowing lines may come off and be ejected at high speed. People may be seriously injured.
  - ▶ Work only with an undamaged mowing head.
  - ▶ Never use metal objects in place of the nylon mowing lines.
  - ▶ Observe and remain inside the wear limits.
  - ▶ If you are unsure: Consult a STIHL authorized dealer.

### 4.6.4 Metal cutting attachment

The metal cutting attachment is in a safe condition if the following points are observed:

- Metal cutting attachment and mounting hardware are undamaged.
- The metal cutting attachment is not warped.
- The metal cutting attachment is properly installed and firmly tightened.
- The metal cutting attachment is correctly sharpened.
- Cutting edges of the metal cutting attachment have no burrs.
- The wear limits are not exceeded.
- If a metal cutting attachment not manufactured by STIHL is used, it must not be heavier, thicker, of a different shape, of a lower quality, or larger in diameter than the largest metal cutting attachment approved by STIHL.

### ▲ WARNING

- If it is not in a safe condition, parts of the metal cutting attachment may come off and be thrown at high speed. People may be seriously injured.

- ▶ Never work with a damaged metal cutting attachment or damaged mounting hardware.
- ▶ Sharpen the metal cutting attachment correctly.
- ▶ Deburr the cutting edges with a file.
- ▶ Have the metal cutting attachment balanced by a STIHL servicing dealer.
- ▶ Observe and remain inside the wear limits.
- ▶ Use a metal cutting attachment specified in these instructions for use.
- ▶ If you are unsure: Consult a STIHL authorized dealer.

#### 4.6.5 Battery

The battery is in a safe condition if the following points are observed:

- Battery is undamaged.
- The battery is clean and dry.
- Battery functions properly and has not been modified.

### ⚠ WARNING

- A battery that is not in a safe condition cannot operate safely. Persons may be seriously injured.
  - ▶ Never work with a damaged battery.
  - ▶ Never attempt to charge a damaged or defective battery.
  - ▶ If the battery is dirty: Clean the battery.
  - ▶ If the battery is wet or damp: Allow the battery to dry,  21.4.
  - ▶ Never attempt to modify the battery.
  - ▶ Never insert objects in the battery's openings.
  - ▶ Never bridge the battery's contacts with metallic objects (short circuit).
  - ▶ Do not open the battery.
  - ▶ Replace worn or damaged labels.
- Fluid may leak from a damaged battery. If that liquid comes into contact with the skin or eyes, the skin or eyes may be irritated.
  - ▶ Avoid contact with the liquid.
  - ▶ If skin contact occurs: Wash affected areas of skin with plenty of water and soap.
  - ▶ In the event of contact with eyes: Rinse eyes with plenty of water for at least 15 minutes and consult a doctor.
- A damaged or defective battery may smell unusual, emit smoke or burn. Persons may be seriously or fatally injured, and property may be damaged.
  - ▶ If the battery smells unusual or emits smoke: do not use the battery and keep it away from combustible substances.

- ▶ If the battery catches fire: Attempt to extinguish the battery with a fire extinguisher or water.

## 4.7 Working

### ⚠ WARNING

- In certain situations, the user may no longer be able to concentrate on their work. This may result in the user stumbling, falling and suffering serious injury.
  - ▶ Work calmly and methodically.
  - ▶ If light and visibility are poor: Do not use your brushcutter.
  - ▶ Operate the brushcutter alone.
  - ▶ Keep the cutting attachment close to the ground and horizontal to the surface.
  - ▶ Watch out for obstacles.
  - ▶ Work standing on the ground and keep your balance.
  - ▶ If you start feeling fatigue: Take a break.
- The rotating cutting attachment can cut the user. This may result in serious injury to the user.
  - ▶ Do not touch the rotating cutting attachment.
  - ▶ If the cutting attachment is blocked by an object: Switch off the brushcutter and remove the battery. Only then remove the object.
- If the behavior of the brushcutter changes during operation or feels unusual, it may no longer be in a safe condition. This may result in serious injury to people and damage to property.
  - ▶ Stop working, remove the battery and consult a STIHL authorized dealer.
- Vibrations may occur while using the brushcutter.



- ▶ Wear gloves.
- ▶ Take breaks.
- ▶ If signs of a circulatory disorder occur: Consult a doctor.
- If the cutting attachment makes contact with a foreign object during operation, the object or parts of it may be ejected at high speed. Persons may be injured or property may be damaged.
  - ▶ Remove foreign objects from the working area.
- If the rotating cutting attachment makes contact with a hard object, sparks may occur and the cutting attachment may be damaged.



Sparks can cause fires in a flammable environment. Persons may be seriously or fatally injured, and property may be damaged.

- ▶ Do not use in a flammable environment.
- ▶ Make sure the cutting attachment is in a safe condition.
- Note that the cutting attachment continues to rotate for a short period after you release the trigger. People may be seriously injured.
  - ▶ Wait until the cutting attachment comes to a complete stop.
- In an emergency, the user may start to panic and forget to take off the carrying system. This may result in serious injury to the user.
  - ▶ Practice taking off the carrying system.

## 4.8 Reactive forces

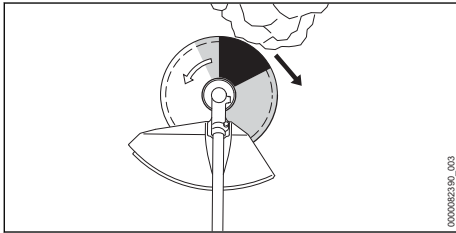

Kickout can be caused for the following reasons:

- The shaded area or the black area of the rotating metal cutting attachment comes into contact with a solid object and is suddenly braked.
- The rotating metal cutting attachment gets pinched in the cut.

The risk of kickout is greatest in the black area.

### ▲ WARNING

- These situations can abruptly decelerate or stop rotation of the cutting attachment and cause the cutting attachment to be thrown to the right or in the direction of the user (black arrow). The user can lose control of the trimmer. There is a risk of serious or fatal injury.
  - ▶ Hold the trimmer firmly with both hands.
  - ▶ Work as described in this User Manual.
  - ▶ Do not use the black area for cutting.
  - ▶ Use a combination of cutting attachment, deflector and carrying system recommended in this User Manual.
  - ▶ Sharpen the metal cutting attachment correctly.
  - ▶ Work with the engine running at full throttle.

## 4.9 Transporting

### 4.9.1 Brushcutter

#### ▲ WARNING

- The gear housing can get hot during operation. There is a risk of burn injuries.
  - ▶ Do not touch a hot gear housing.



- The brushcutter may tilt over or shift during transport. Persons may be injured or property damaged.



- ▶ Remove the battery.

- ▶ If a metal cutting attachment is mounted: Fit the transport guard.
- ▶ Secure the brushcutter with lashing straps, belts or a net to prevent it turning over and moving.

### 4.9.2 Battery

#### ▲ WARNING

- The battery is not protected against all ambient conditions. The battery may be damaged if it is exposed to certain ambient conditions, and damage to property may occur.
  - ▶ Never transport a damaged battery.
- The battery may turn over or shift during transport. This may result in injury to people and damage to property.
  - ▶ Pack the battery in packaging in such a way that it cannot move.
  - ▶ Secure the packaging so that it cannot move.

## 4.10 Storing

### 4.10.1 Brushcutter

#### ▲ WARNING

- Children are not aware of and cannot assess the dangers of a brushcutter and can be seriously injured.



- ▶ Remove the battery.

- ▶ If a metal cutting attachment is mounted: Fit the transport guard.
- ▶ Store the brushcutter out of the reach of children.

- Dampness can corrode the electrical contacts on the brushcutter and metal components. This can damage the brushcutter.



- ▶ Remove the battery.

- ▶ Store the brushcutter in a clean and dry condition.

#### 4.10.2 Battery

### ▲ WARNING

- Children are not aware of and cannot assess the dangers of the battery. Children may be seriously injured.
  - ▶ Store the battery out of the reach of children.
- The battery is not protected against all ambient conditions. If the battery is exposed to certain ambient conditions, the battery may be irreparably damaged.
  - ▶ Store the battery in a clean and dry condition.
  - ▶ Store the battery in an enclosed space.
  - ▶ Store the battery separately from the brushcutter.
  - ▶ If the battery is stored in the charger, disconnect the mains plug and store the battery at a state of charge between 40% and 60% (2 lit green LEDs).
  - ▶ Do not store the battery outside of the specified temperature limits, 21.3.

#### 4.11 Cleaning, Maintenance and Repair

### ▲ WARNING

- The brushcutter may start up unintentionally if the battery is left in place during cleaning, maintenance or repair operations. This may result in serious injury to people and damage to property.



- ▶ Remove the battery.

- The gear housing can get hot during operation. There is a risk of burn injuries.
  - ▶ Do not touch a hot gear housing.



- Aggressive cleaning agents, a water jet or pointed objects can damage the trimmer, deflector, cutting attachment or battery. If the brushcutter, deflector, cutting attachment or

battery are not cleaned correctly, components may no longer function properly or safety devices may be rendered inoperative. They may cause serious injury to persons.

- ▶ Clean the brushcutter, deflector, cutting attachment and battery as described in this User Manual.
- If the brushcutter, deflector, cutting attachment or battery are not serviced or repaired correctly, components may no longer function properly or safety devices may be rendered inoperative. This may result in serious or fatal injury to people.
  - ▶ Do not attempt to service or repair the brushcutter, deflector or battery yourself.
  - ▶ If the brushcutter, the deflector or the battery require servicing or repairs, contact your STIHL dealer for assistance.
  - ▶ Maintain the cutting attachment as described in the User Manual supplied with the cutting attachment being used or on the cutting attachment's packaging.
- The user can be cut by the sharp cutting edges while cleaning or maintaining cutting attachments. This may result in injury to the user.



- ▶ Wear work gloves made from resistant material.

## 5 Preparing Trimmer for Operation

### 5.1 Preparing the Brushcutter for Operation

The following steps must be performed before commencing work:

- ▶ Ensure that the following components are in a safe condition:
  - Brushcutter, 4.6.1.
  - Deflector, 4.6.2.
  - Mowing head or metal cutting attachment, 4.6.3 or 4.6.4.
  - Battery, 4.6.5.
- ▶ Check the battery, 12.2.
- ▶ Fully charge the battery as described in the user manual for the STIHL AL 101, 301, 301-4, 500 chargers.
- ▶ Clean the brushcutter, 17.1.
- ▶ Mount the loop handle, 8.1.
- ▶ Select combination of cutting attachment, deflector and carrying system, 22.1.
- ▶ Mount the deflector, 8.3.1.

- ▶ If a metal cutting attachment is used: mount the barrier bar, [📖 8.2](#).
- ▶ Mount the mowing head or metal cutting attachment, [📖 8.4.1](#) or [📖 8.5.1](#).
- ▶ Put on and adjust the carrying system, [📖 9.1](#).
- ▶ Adjust the loop handle, [📖 9.2](#).
- ▶ Balance the brushcutter, [📖 9.3](#).
- ▶ Check the controls, [📖 12.1](#).
- ▶ If you cannot carry out this work: do not use your brushcutter and contact your STIHL authorized dealer for assistance.

## 5.2 Connecting a battery with Bluetooth® radio interface with the STIHL connected app

- ▶ Activate the Bluetooth® radio interface on the mobile device.
- ▶ Activating the Bluetooth® radio interface on the battery, [📖 7.1](#).
- ▶ Download the STIHL connected app to the mobile device from the App Store and create an account.
- ▶ Open and sign in to the STIHL connected app.
- ▶ Add the battery in the STIHL connected app and follow the instructions on the screen.

For contacts and other information, please visit <https://support.stihl.com> or see the STIHL connected app.

The STIHL connected app is available internationally.

## 6 Charging the Battery, LEDs

### 6.1 Charging the Battery

The charging time depends on various factors, e.g. the battery temperature or the ambient temperature. For optimum performance, observe the recommended temperature ranges, [📖 21.4](#). The actual charging time may vary from the charging time indicated. The charging time is indicated at [www.stihl.com/charging-times](http://www.stihl.com/charging-times).

- ▶ Recharge the battery as described in the User Manual for the STIHL AL 101, 301, 301-4, 500 chargers.

### 6.2 Displaying the charge level

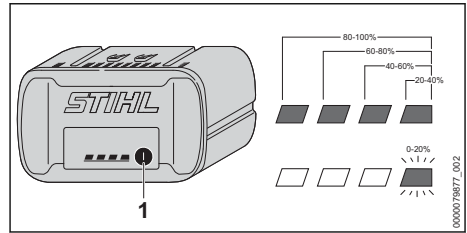

- ▶ Press the button (1).  
The LEDs light up green for about 5 seconds and indicate the state of charge.
- ▶ If the LED on the right flashes green: Charge the battery.

### 6.3 LEDs on Battery

The LEDs can show the state of charge or malfunctions. The LEDs can glow or flash green or red.

The state of charge is indicated when the LEDs glow or flash green.

- ▶ If the LEDs glow or flash red: Troubleshooting, [📖 20.1](#).  
Malfunction in trimmer or battery.

## 7 Activating and Deactivating Bluetooth® Radio Interface

### 7.1 Activating the Bluetooth® Radio Interface

- ▶ If the battery has a Bluetooth® radio interface: Press and hold the pushbutton until the "BLUETOOTH®" LED next to the  symbol lights up blue for approximately 3 seconds. The Bluetooth® radio interface on the battery is activated.

### 7.2 Deactivating the Bluetooth® Radio Interface

- ▶ If the battery has a Bluetooth® radio interface: Press and hold the pushbutton until the "BLUETOOTH®" LED next to the  symbol lights up blue six times. The Bluetooth® radio interface on the battery is deactivated.

## 8 Assembling the Trimmer

### 8.1 Attaching the loop handle

- ▶ Switch off the brushcutter and remove the battery.

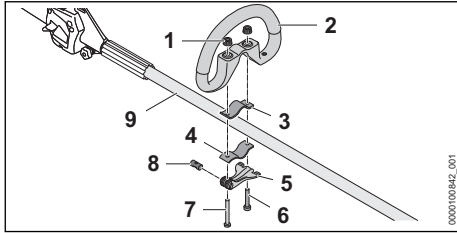

- ▶ Insert the pin (8) into the opening in the quick release clamp (5). Align the pin (8) so that the notch of the pin is at the bottom.
- ▶ Place the clamp (3) in the loop handle so that the holes are aligned.
- ▶ Place the loop handle (2) with clamp (3) on the shaft (9).
- ▶ Insert the long screw (7) through the holes in the pin and quick release clamp (5).
- ▶ Press the clamp (4) against the shaft so that the holes are aligned.
- ▶ Insert the short screw (6) through the holes.
- ▶ Insert the long screw (7) through the holes.
- ▶ Screw on the knurled nuts (1).
- ▶ Close the quick release clamp (5).

The loop handle (2) is properly adjusted if it can no longer be moved.

- ▶ If the loop handle (2) can be moved:
  - ▶ Open the quick release clamp (5).
  - ▶ Tighten the knurled nuts (1).
  - ▶ Close the quick release clamp (5). The loop handle (2) can no longer be moved.
- ▶ If the quick release clamp (5) cannot be closed:
  - ▶ Open the quick release clamp (5).
  - ▶ Loosen the knurled nuts (1).
  - ▶ Close the quick release clamp (5). The loop handle (2) can no longer be moved.

## 8.2 Attaching the barrier bar

- ▶ Switch off the brushcutter and remove the battery.

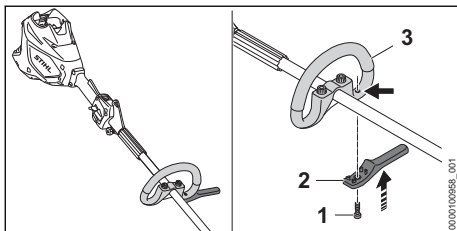

- ▶ Place the barrier bar (2) on the loop handle (3). The barrier bar should close flush with the loop handle.
- ▶ Screw in and securely tighten the screw (1).

## 8.3 Mounting and Removing the Deflector

### 8.3.1 Attaching the deflector

- ▶ Switch off the brushcutter and remove the battery.

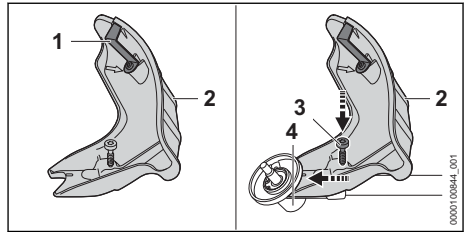

The line limiting blade (1) has already been installed in the guard (2) and must not be removed.

- ▶ Push the deflector (2) into the guides on the gear housing up to the limit stop.
- ▶ Insert the screw (3) and tighten it securely.

### 8.3.2 Removing the Deflector

- ▶ Switch off the brushcutter and remove the battery.

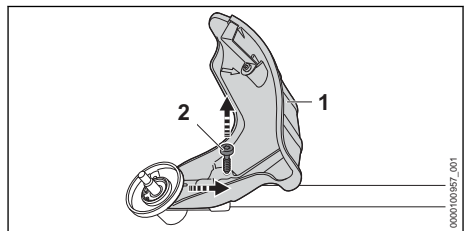

- ▶ Unscrew the screw (2).
- ▶ Pull off the deflector (1).

## 8.4 Mounting and Removing the Mowing Head

### 8.4.1 Mounting the Mowing Head

- ▶ Switch off the brushcutter and remove the battery.

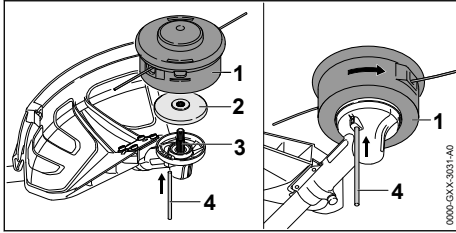

- ▶ Place the thrust plate (2) on the shaft (3) so that its smaller diameter faces up.
- ▶ Fit the mowing head (1) on the shaft (3) and turn it counterclockwise by hand.
- ▶ Insert the stop pin (4) in the bore up to the limit stop and hold it depressed.
- ▶ Turn the mowing head (1) counterclockwise until the stop pin (4) engages in position. The shaft (3) is now blocked.
- ▶ Tighten down the mowing head (1) firmly by hand.
- ▶ Remove the stop pin (4).

#### 8.4.2 Removing the Mowing Head

- ▶ Switch off the brushcutter and remove the battery.
- ▶ Insert the stop pin in the bore up to the limit stop and hold it depressed.
- ▶ Rotate the mowing head until the stop pin engages in position. The shaft is now blocked.
- ▶ Unscrew the mowing head clockwise.
- ▶ Remove the thrust plate.
- ▶ Remove the stop pin.

### 8.5 Removing and Installing Metal Cutting Attachment

#### 8.5.1 Mounting the Metal Cutting Attachment

- ▶ Switch off the brushcutter and remove the battery.

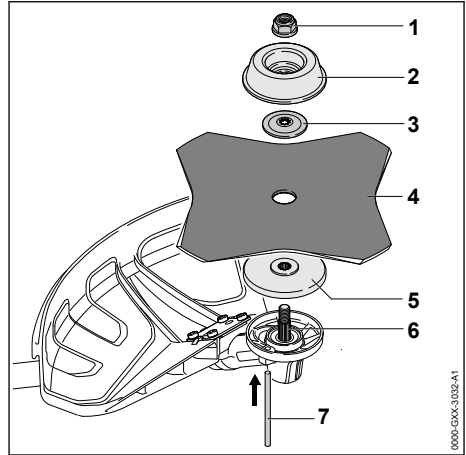

- ▶ Place the thrust plate (5) on the shaft (6) so that its smaller diameter faces up.
- ▶ Place the metal cutting attachment (4) on the thrust plate (5). If you are fitting a circular saw blade or a grass cutting blade with more than 4 cutting edges: Its cutting edges must face in the same direction as the arrow on the deflector.
- ▶ Place the thrust washer (3) on the metal cutting attachment (4) so that its raised side faces up.
- ▶ Place the rider plate (2) on the thrust washer (3) so that its closed side faces up.
- ▶ Insert the stop pin (7) in the bore up to the limit stop and hold it depressed.
- ▶ Rotate the metal cutting attachment (4) counterclockwise until the stop pin (7) engages in position. The shaft (6) is now blocked.
- ▶ Fit the nut (1) counterclockwise and tighten it down firmly.
- ▶ Remove the stop pin (7).

#### 8.5.2 Removing the metal cutting attachment

- ▶ Switch off the brushcutter and remove the battery.
- ▶ Insert the stop pin in the bore up to the limit stop and hold it depressed.
- ▶ Rotate the metal cutting attachment clockwise until the stop pin engages in position. The shaft is now blocked.
- ▶ Unscrew the mounting nut clockwise.
- ▶ Remove the rider plate, thrust washer, metal cutting attachment and thrust plate.
- ▶ Remove the stop pin.

## 9 Adjusting Trimmer for User

### 9.1 Fitting and Adjusting the Carrying System

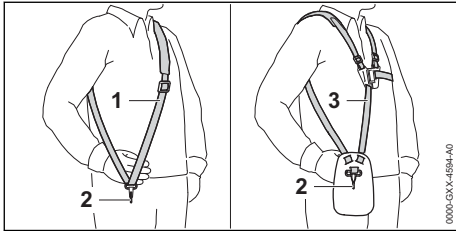

- ▶ Put on the shoulder strap (1) or full harness (3).
- ▶ Adjust the shoulder strap (1) or full harness (3) so that the carabiner (2) is about a hand's width below your right hip.

Other approved carrying systems are listed in this User Manual, [22](#).

### 9.2 Aligning and adjusting the loop handle

The loop handle can be adjusted to different positions to suit the height and reach of the user.

- ▶ Switch off the brushcutter and remove the battery.

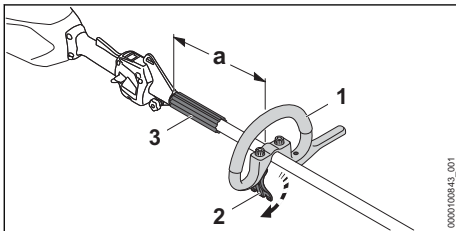

- ▶ Release the quick release clamp (2).
- ▶ Move the loop handle (1) to the required position and check that the following conditions are met:
  - The bump guard (3) fits between the loop handle (1) and carrying ring.
  - If you are using a mowing head:  $a =$  no more than 30 cm
  - If you are using a metal cutting attachment:  $a =$  no more than 25 cm
- ▶ Close the quick release clamp (2) so that the loop handle (1) can no longer be rotated on the shaft.

### 9.3 Balancing the brushcutter

The battery and cutting attachment affect the balance of the brushcutter. The brushcutter must be balanced with the attached cutting attachment and the battery that is used.

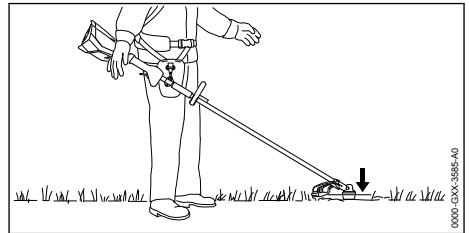

The cutting attachment should rest lightly on the ground.

- ▶ Switching off the brushcutter

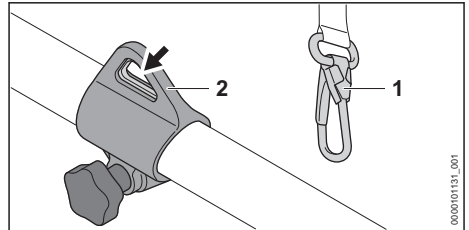

- ▶ Connect the carrying ring (2) to the carabiner (1).
- ▶ Wait for brushcutter to stop swinging.
- ▶ Check the position of the cutting attachment. If it needs adjustment:

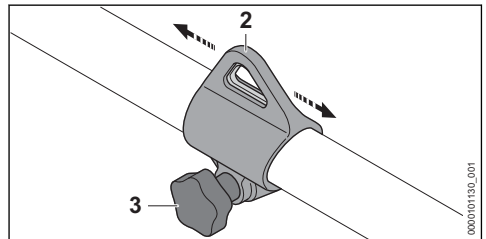

- ▶ Loosen the screw (3).
- ▶ Move the carrying ring (2) up or down the shaft until a correct balanced position is reached.
- ▶ Tighten the screw (3) securely.

## 10 Removing and Fitting the Battery

### 10.1 Inserting the Battery

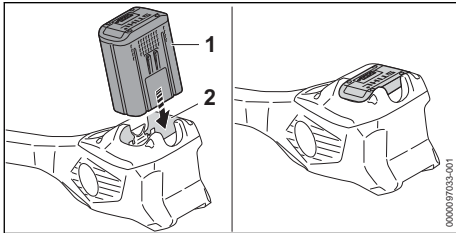

- ▶ Insert the battery (1) up to the limit stop into the battery compartment (2). The battery (1) engages with a click and is now locked.

### 10.2 Removing the Battery

- ▶ Set the brushcutter on a level surface.

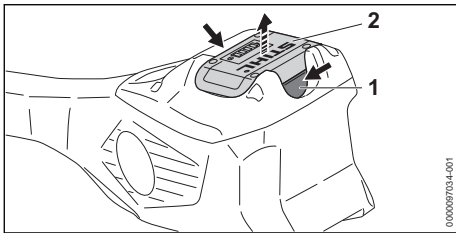

- ▶ Press both locking levers (1). The battery (2) is released and can be removed.

## 11 Switching the Trimmer On/Off

### 11.1 Switching on the brushcutter

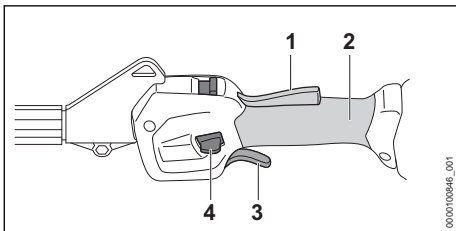

- ▶ Hold the brushcutter firmly with your right hand on the control handle so that your thumb wraps around the grip (2) of the control handle.
- ▶ Hold the brushcutter with your left hand by the loop handle so that your thumb wraps around the loop handle.

- ▶ Depress the ergo lever (1) with your hand and hold it there.
- ▶ Press the release slide (4) down with your thumb.
- ▶ Press the trigger (3) with your index finger and keep it depressed. The brushcutter accelerates and the cutting attachment rotates.

The more the trigger (3) is depressed, the faster the rotation of the cutting attachment.

At the maximum power level, the brushcutter identifies the cutting attachment used and automatically sets the maximum speed.

### 11.2 Switching off the brushcutter

- ▶ Release the trigger and the Ergo lever.
- ▶ Wait for the cutting attachment to stop rotating.
- ▶ If the cutting attachment continues to rotate: Remove the battery and contact your STIHL dealer. The brushcutter is defective.

## 12 Testing the Trimmer and Battery

### 12.1 Checking the controls

#### Release slide, ergo lever and trigger

- ▶ Remove the battery.
- ▶ Try squeezing the trigger switch without activating the release slide.
- ▶ If you can press the trigger: Stop using your brushcutter and contact a STIHL authorized dealer. The release slide is faulty.
- ▶ Press and hold the release slide.
- ▶ Press and hold the ergo lever.
- ▶ Press the trigger. The release slide can be released.
- ▶ Release the trigger and ergo lever.
- ▶ If the release slide, trigger or ergo lever is stiff or does not spring back to the initial position: Stop using the brushcutter and contact a STIHL authorized dealer. The release slide, trigger or ergo lever is defective.

#### Switching on the brushcutter

- ▶ Insert the battery.
- ▶ Press and hold the release slide.
- ▶ Press and hold the trigger. The cutting attachment rotates.

- ▶ If 3 LEDs flash red: Remove the battery and consult a STIHL authorized dealer. The brushcutter has a malfunction.
- ▶ Release the trigger.
- ▶ The cutting attachment stops rotating after a short period of time.
- ▶ If the cutting attachment continues to rotate: Remove the battery and contact a STIHL authorized dealer. The brushcutter is defective.

## 12.2 Testing the Battery

- ▶ Press button on battery. The LEDs glow or flash.
- ▶ If the LEDs do not glow or flash: Do not use the battery and contact your STIHL servicing dealer. There is a malfunction in the battery.

## 13 Operating the Trimmer

### 13.1 Holding and guiding the brushcutter

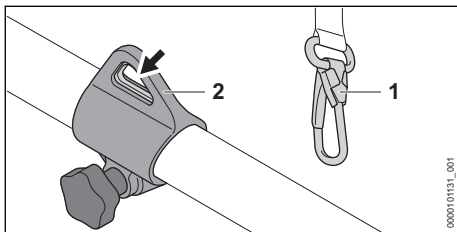

- ▶ Connect the carrying ring (2) to the carabiner (1).

If you are using a mowing head:

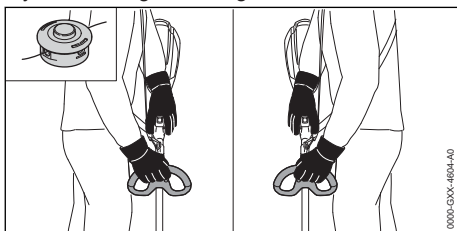

- ▶ Hold the brushcutter firmly with one hand on the control handle so that your thumb wraps around the grip of the control handle.
- ▶ Hold the brushcutter with your other hand on the loop handle so that your thumb wraps around the loop handle.

If you are using a metal cutting attachment:

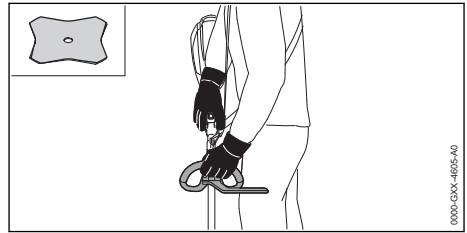



- ▶ Hold the brushcutter firmly with one hand on the control handle so that your thumb wraps around the grip of the control handle.
- ▶ Hold the brushcutter with your other hand on the loop handle so that your thumb wraps around the loop handle.

### 13.2 Setting the power level

Depending on the application, 2 power levels can be set. The position of the power level slide (1) shows the power level that has been set.

The selected power level affects the battery's runtime.

-  **ECO** : ECO power level, low performance
-  Maximum power level, maximum performance.

When the maximum power level is set, the brushcutter recognizes the cutting attachment that has been attached and automatically adjusts the appropriate speed of the blade.

When the Eco power level is selected, the speed is reduced.

This can extend the battery runtime.

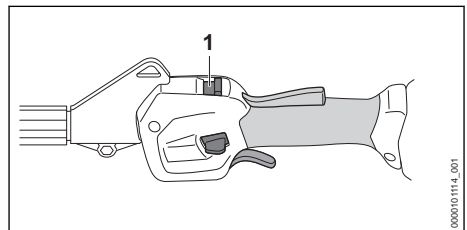

- ▶ Use your thumb to slide the power level slide (1) into the desired position.



### 13.3 Mowing

The cutting height is determined by the distance of the cutting attachment from the ground.

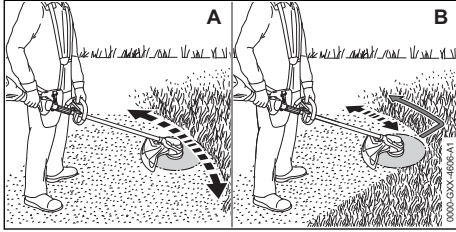

#### Mowing with a mowing head (A)

- ▶ Swing the brushcutter steadily back and forth in an arc.
- ▶ Walk forward slowly and steadily.

#### Mowing with a grass cutting blade (B)

- ▶ Mow with the left part of the metal cutting attachment.
- ▶ Walk forward slowly and steadily.

For optimum performance, observe the recommended temperature ranges, 21.4.

## 13.4 Adjusting Nylon Line

### 13.4.1 Line Feed on AutoCut Mowing Heads

- ▶ Briefly tap the rotating mowing head on the ground. About 30 mm of fresh nylon line is advanced. The line limiting blade in the deflector automatically cuts the mowing lines to the correct length.

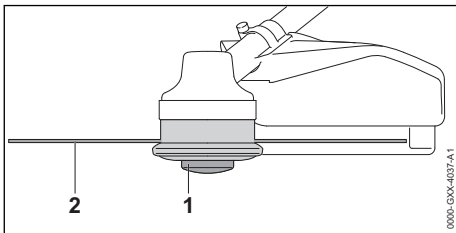

Automatic feed will not take place if the mowing lines are shorter than 25 mm.

- ▶ Switch off the brushcutter and remove the battery.
- ▶ Depress the spool (1) on the mowing head and hold it depressed.
- ▶ Pull out the mowing lines (2) by hand.
- ▶ If the mowing lines (2) cannot be pulled out to the required length: Replace the spool (1) or the mowing lines (2). The spool is empty.

### 13.4.2 Line Feed on SuperCut Mowing Heads

Mowing lines are advanced automatically. The line limiting blade in the deflector automatically cuts the mowing lines to the correct length.

Automatic feed will not take place if the mowing lines are shorter than 40 mm.

- ▶ Switch off the brushcutter and remove the battery.
- ▶ Pull out the mowing lines by hand.
- ▶ If the mowing lines cannot be pulled out to required length: Replace the mowing lines. The spool is empty.

## 14 After Finishing Work

### 14.1 After finishing work

- ▶ Switch off the brushcutter and remove the battery.
- ▶ If the brushcutter is wet: Allow the brushcutter to dry.
- ▶ If the battery is moist or wet: Allow the battery to dry, 21.4.
- ▶ Clean the brushcutter.
- ▶ Clean the deflector.
- ▶ Clean the cutting attachment.
- ▶ Clean the battery.
- ▶ If a metal cutting attachment is attached: Attach the appropriate transport guard.

## 15 Transporting

### 15.1 Transporting the brushcutter

- ▶ Switch off the brushcutter and remove the battery.
- ▶ If a metal cutting attachment is mounted: Fit the matching transport guard.

#### Carrying the brushcutter

- ▶ Carry the brushcutter in one hand properly balanced by the shaft, with the cutting attachment behind you.

#### Transporting the brushcutter in the car

- ▶ Secure the brushcutter to prevent turnover and movement.

### 15.2 Transporting the Battery

- ▶ Switch off the brushcutter and remove the battery.
- ▶ Check that the battery is in a safe condition.
- ▶ Pack the battery in packaging in such a way that it cannot move inside the packaging.
- ▶ Secure the packaging so that it cannot move.

The battery is subject to the Carriage of Dangerous Goods regulations. The battery is classified

as UN 3480 (lithium ion batteries) and has been tested pursuant to UN Manual Tests and Criteria Part III, Subsection 38.3.

The transport regulations can be found at [www.stihl.com/safety-data-sheets](http://www.stihl.com/safety-data-sheets).

## 16 Storing

### 16.1 Storing the brushcutter

- ▶ Switch off the brushcutter and remove the battery.
- ▶ If a metal cutting attachment is mounted: Attach the appropriate transport guard.
- ▶ Ensure that the following conditions are met when storing the brushcutter:
  - The brushcutter cannot tip over or shift.
  - The brushcutter is out of the reach of children.
  - The brushcutter is clean and dry.
- ▶ If you store the brushcutter for more than 30 days: Remove the cutting attachment.

### 16.2 Storing the Battery

STIHL recommends keeping the battery in a charging state between 40% and 60 % (2 green LEDs lit).

- ▶ The battery should be stored in such a way that the following conditions are fulfilled:
  - The battery is out of the reach of children.
  - The battery is clean and dry.
  - The battery is in an enclosed space.
  - The battery is separated from the brushcutter.
  - If the battery is stored in the charger, disconnect the mains plug and store the battery at a state of charge between 40% and 60% (2 lit green LEDs).
  - Do not store the battery outside of the specified temperature limits,  21.3.

#### NOTICE

- If the battery is not stored as described in this User Manual, the battery may become deeply discharged and irreparably damaged.
  - ▶ Charge a discharged battery before storing it. STIHL recommends keeping the battery state of charge between 40% and 60% (2 lit green LEDs).
  - ▶ Store the battery separately from the brushcutter.

## 17 Cleaning

### 17.1 Cleaning the Brushcutter

- ▶ Switch off the brushcutter and remove the battery.
- ▶ Clean the brushcutter with a damp cloth.
- ▶ Clean vents with a paintbrush.
- ▶ Remove foreign objects from the battery compartment and clean the battery compartment with a damp cloth.
- ▶ Clean the electrical contacts in the battery compartment with a paintbrush or soft brush.

### 17.2 Cleaning the Deflector and Cutting Attachment

- ▶ Switch off the trimmer and remove the battery.
- ▶ Clean the deflector and cutting attachment with a damp cloth or a soft brush.

### 17.3 Cleaning the Battery

- ▶ Clean the battery with a damp cloth.

## 18 Maintenance

### 18.1 Maintenance Intervals

The maintenance intervals are dependent on the environmental and operating conditions. STIHL recommends the following maintenance intervals:

#### Every 12 months

- ▶ Have the trimmer checked by a STIHL servicing dealer.

### 18.2 Sharpening and Balancing a Metal Cutting Attachment

Correctly sharpening and balancing metal cutting attachments requires a lot of practice.

STIHL recommends you have metal cutting attachments resharpened and balanced by a STIHL servicing dealer.

- ▶ Sharpen the metal cutting attachment as described in the instructions and on the packaging supplied with the cutting attachment you are using.

## 19 Repairing

### 19.1 Repairing the Trimmer and Cutting Attachment

The trimmer and cutting attachment cannot be repaired by the user.

- ▶ If the trimmer or cutting attachment is damaged: Do not use your trimmer or cutting attachment and contact your STIHL servicing dealer.
- ▶ If the battery has a malfunction or is damaged: Replace the battery.



## 19.2 Servicing and Repairing the Battery

The battery requires no servicing and cannot be repaired.

# 20 Troubleshooting

## 20.1 Troubleshooting the brushcutter or battery

Fault	LEDs on the battery	Cause	Remedy
The brushcutter does not start when switched on.	1 LED flashes green.	The state of charge of the battery is too low.	▶ Recharge the battery fully as described in the User Manual for the STIHL AL 101, 301, 301-4, 500 chargers.
	1 LED lights up red.	The battery is too warm or too cold.	▶ Remove the battery. ▶ Allow the battery to cool down or warm up.
	3 LEDs flash red.	The brushcutter has a malfunction.	▶ Remove the battery. ▶ Clean the electrical contacts in the battery compartment. ▶ Insert battery. ▶ Switch on the brushcutter. ▶ If 3 LEDs continue to flash red: Do not use your brushcutter; contact a STIHL authorized dealer for assistance.
	3 LEDs light up red.	The brushcutter is too hot.	▶ Remove the battery. ▶ Allow the brushcutter to cool down.
	4 LEDs flash red.	There is a fault in the battery.	▶ Remove the battery and reinsert it. ▶ Switch on the brushcutter. ▶ If 4 LEDs continue to flash red: Do not use the battery; contact a STIHL authorized dealer.
		No electrical contact between brushcutter and battery.	▶ Remove the battery. ▶ Clean electrical contacts in the battery compartment. ▶ Insert battery.
		The brushcutter or battery is damp.	▶ Allow the brushcutter or battery to dry,  21.4.
		Trigger is pressed before activating the release slide.	▶ Switch on the brushcutter as described in this User Manual.
The brushcutter cuts out during operation.	3 LEDs light up red.	The brushcutter is too hot.	▶ Remove the battery. ▶ Allow the brushcutter to cool down.
		There is an electrical fault.	▶ Remove the battery and reinsert it. ▶ Switch on the brushcutter.
The runtime of the brushcutter is too short.		The battery is not fully charged.	▶ Recharge the battery fully as described in the User Manual for the STIHL AL 101, 301, 301-4, 500 chargers.
		The battery service life has been exceeded.	▶ Replace battery.

Fault	LEDs on the battery	Cause	Remedy
The power levels cannot be set.		The trigger is pressed and the brushcutter is switched on.	▶ Select the power level as described in this User Manual.
The mowing head cannot be removed by hand.		The mowing head is overtightened.	▶ Block the fanwheel with the stop pin. ▶ Unscrew the mowing head by hand. ▶ Remove the stop pin.
STIHL connected app is unable to find the battery with  .		Bluetooth® interface on the battery or mobile device is deactivated.	▶ Activate Bluetooth® interface on the battery or mobile device.
		The distance between the battery and mobile device is too great.	▶ Reduce the distance,  21.1. ▶ If the battery still cannot be found with the STIHL connected app: Contact a STIHL authorized dealer for assistance.

## 20.2 Product Support and Assistance on Use

Product support and assistance on use are available from STIHL servicing dealers.

For contacts and other information, please visit <https://support.stihl.com> or [www.stihl.com](http://www.stihl.com).

## 21 Specifications

### 21.1 STIHL FSA 120.0 R Brushcutters

- Permitted batteries:
  - STIHL AP
  - STIHL AR
- Weight without battery, cutting attachment and deflector: 4.3 kg
- Length without cutting attachment: 1788 mm
- Degree of protection: IPX4 (protection against splash water from any direction)

For runtime, see [www.stihl.com/battery-life](http://www.stihl.com/battery-life).

### 21.2 STIHL AP battery

- Battery technology: lithium-ion
- Voltage: 36 V
- Capacity in Ah: see rating label
- Energy content in Wh: see rating label
- Weight in kg: see rating label
- Bluetooth® radio interface (only for batteries with ):
  - Data connection: Bluetooth® 5.1. The mobile appliance must be compatible with Bluetooth® Low Energy 5.0 and support Generic Access Profile (GAP).
  - Frequency band: ISM band 2.4 GHz
  - Maximum RF power transmitted: 1 mW

- Signal range: approx. 10 m. The signal strength depends on the ambient conditions and the mobile terminal. Signal range can vary greatly depending on local conditions, including the receiver. The range may be perceptibly reduced inside enclosed rooms and through metal barriers (such as walls, shelves or cases).
- Mobile appliance operating system requirements: Android or iOS (current version or higher)

### 21.3 Temperature limits

#### WARNING

- The battery is not protected against all ambient conditions. If the battery is exposed to certain environmental conditions, it may catch fire or explode. This may result in serious injury to people and damage to property.
  - ▶ Do not charge the battery below -20°C or above 50°C.
  - ▶ Do not use the brushcutter or battery below -20°C or above 50°C.
  - ▶ Do not store the brushcutter or battery below -20°C or above 70°C.

### 21.4 Recommended temperature ranges

For optimum performance of the brushcutter and battery, note the following temperature ranges:

- Charging: 5°C to 40°C
- Use: -10°C to +40°C
- Storage: -20°C to +50°C

If the battery is charged, used or stored outside the recommended temperature ranges, performance may be restricted.

If the battery is wet or moist, allow the battery to dry for at least 48 h between 15°C and 50°C and with less than 70% humidity. Higher humidity may extend the drying time.

## 21.5 Sound Values and Vibration Values

The K value for the sound pressure level is 2 dB(A). The K value for the sound power level is 2 dB(A). The K value for the vibration level is 2 m/s<sup>2</sup>.

STIHL recommends wearing hearing protection.

### Using with a mowing head except PolyCut 18-2

- Sound pressure level  $L_{pA}$  measured as specified in IEC 62841-4-4: 81 dB(A)
- Sound power level  $L_{WA}$  measured in accordance with IEC 62841-4-4: 94 dB(A)
- Vibration value  $a_{hv}$  measured as specified in IEC 62841-4-4
  - Control handle: 2.8 m/s<sup>2</sup>
  - Loop handle: 5.8 m/s<sup>2</sup>

### Using with a PolyCut 18-2 mowing head

- Sound pressure level  $L_{pA}$  measured as specified in IEC 62841-4-4: 82 dB(A)
- Sound power level  $L_{WA}$  measured in accordance with IEC 62841-4-4: 93 dB(A)
- Vibration value  $a_{hv}$  measured as specified in IEC 62841-4-4
  - Control handle: 1.6 m/s<sup>2</sup>
  - Loop handle: 3.2 m/s<sup>2</sup>

### Using with a metal cutting attachment

- Sound pressure level  $L_{pA}$  measured as specified in IEC 62841-4-4: 81 dB(A)
- Sound power level  $L_{WA}$  measured in accordance with IEC 62841-4-4: 94 dB(A)
- Vibration value  $a_{hv}$  measured as specified in IEC 62841-4-4
  - Control handle: 2.9 m/s<sup>2</sup>
  - Loop handle: 3.7 m/s<sup>2</sup>

The vibration levels indicated were measured according to a standardized test method and can be used as a basis for comparing electric power tools. The vibration levels actually occurring may vary from the values indicated, depending on the type of application. The vibration levels indicated can be used for an initial estimate of the vibration stress. The actual vibration stress has to be estimated. The times can be taken into account in the estimate when the electric power tool is switched off and also when it is switched on but running without any load.

For information on compliance with the Physical Agents (Vibration) Directive 2002/44/EC, see [www.stihl.com/vib](http://www.stihl.com/vib).

## 21.6 REACH

REACH is an EC regulation and stands for the Registration, Evaluation, Authorisation and Restriction of Chemical substances.

For information on compliance with the REACH regulation see [www.stihl.com/reach](http://www.stihl.com/reach).

# 22 Combinations of Cutting Attachments, Deflectors and Carrying Systems

## 22.1 Combinations of cutting attachments, deflectors and carrying systems

Cutting attachment	Deflector	Barrier bar	Carrying system
<ul style="list-style-type: none"> <li>– PolyCut 18-2 mowing head (Ø 335 mm)</li> </ul> Mowing head with "round, quiet" mowing lines with a diameter of 2.4 mm: <ul style="list-style-type: none"> <li>– AutoCut 25-2 mowing head</li> <li>– AutoCut C 26-2 mowing head</li> <li>– AutoCut 27-2 mowing head</li> <li>– DuroCut 20-2 mowing head</li> <li>– SuperCut mowing head 20-2</li> <li>– TrimCut C 32-2 mowing head</li> </ul>	<ul style="list-style-type: none"> <li>– Deflector for mowing heads (Ø 380 mm)</li> </ul>	<ul style="list-style-type: none"> <li>– optional</li> </ul>	<ul style="list-style-type: none"> <li>– Shoulder strap</li> <li>– Full harness with quick-release system</li> <li>– STIHL AR battery with the support cushion</li> <li>– Battery belt with attached "AP belt bag with connecting cable" together with the shoulder strap</li> <li>– Battery belt with strap and attached "AP belt bag with connecting cable" together with the support cushion</li> <li>– Carrying system with built-in "AP belt bag with connecting cable" together with the support cushion</li> </ul>
<ul style="list-style-type: none"> <li>– Grass cutting blade 230-2 (Ø 230 mm)</li> <li>– Grass cutting blade 230-4 (Ø 230 mm)</li> </ul>	<ul style="list-style-type: none"> <li>– Deflector for metal cutting attachments (Ø 230 mm)</li> </ul>	<ul style="list-style-type: none"> <li>– required</li> </ul>	

Cutting attachment	Deflector	Barrier bar	Carrying system
– Grass cutting blade 230-8 (Ø 230 mm)			

## 23 Spare Parts and Accessories

### 23.1 Spare parts and accessories

**STIHL** These symbols indicate original STIHL spare parts and original STIHL accessories.

STIHL recommends the use of original STIHL spare parts and accessories.

Despite ongoing market observation, STIHL is unable to judge the reliability, safety and suitability of other manufacturers' spare parts and accessories; accordingly, STIHL cannot warrant for the use of those parts.

Original STIHL spare parts and original STIHL accessories are available from STIHL dealers.

## 24 Disposal

### 24.1 Disposing of the Trimmer and Battery

Contact the local authorities or your STIHL dealer for information on disposal.

Improper disposal can be harmful to health and pollute the environment.

- ▶ Take STIHL products including packaging to a suitable collection point for recycling in accordance with local regulations.
- ▶ Do not dispose with domestic waste.

## 25 EC Declaration of Conformity

### 25.1 STIHL FSA 120.0 R Brushcutter

ANDREAS STIHL AG & Co. KG  
Badstraße 115  
D-71336 Waiblingen

Germany

declares under our sole responsibility that

- Designation: Cordless brushcutter
- Machine category: trimmer, clearing saw
- Manufacturer's brand: STIHL
- Model: FSA 120.0 R
- Serial identification number: FA08

conforms to the relevant provisions of Directives 2011/65/EU, 2006/42/EC, 2014/30/EU and

2000/14/EC, and has been developed and manufactured in compliance with the following standards in the versions valid on the date of production: EN 55014-1, EN 55014-2, EN 62841-1 and ISO 12100, taking account of IEC 62841-4-4, EN 60335-1 and EN 50636-2-91.

The measured and guaranteed sound power levels were determined according to Directive 2000/14/EC, Annex VI.

Participating notified body: VDE Prüf- u. Zertifizierungsinstitut, Merianstraße 28, 63069 Offenbach, Germany

- Measured sound power level: 94 dB(A)
- Guaranteed sound power level: 96 dB(A)

The technical documents are stored at ANDREAS STIHL AG & Co. KG Produktzulassung.

The year of manufacture, country of manufacture and serial number are specified on the rating plate of the brushcutter.

Waiblingen, 2022-10-15

ANDREAS STIHL AG & Co. KG

pp 

Robert Olma, Vice President, Regulatory Affairs & Global Governmental Relations

## 26 UKCA Declaration of Conformity

### 26.1 STIHL FSA 120.0 R Brushcutter

**UK  
CA**

ANDREAS STIHL AG & Co. KG  
Badstraße 115  
D-71336 Waiblingen

Germany

declares under our sole responsibility that

- Designation: Cordless brushcutter
- Machine category: trimmer, clearing saw
- Manufacturer's brand: STIHL
- Model: FSA 120.0 R

– Serial identification number: FA08

complies with the relevant provisions of the UK regulations The Restriction of the Use of Certain Hazardous Substances in Electrical and Electronic Equipment Regulations 2012, Supply of Machinery (Safety) Regulations 2008, Electro-magnetic Compatibility Regulations 2016 and Noise Emission in the Environment by Equipment for use Outdoors Regulations 2001 and has been developed and manufactured in accordance with the versions of the following standards valid on the date of manufacture: EN 55014-1, EN 55014-2, EN 62841-1 und ISO 12100, taking into account standards IEC 62841-4-4, EN 60335-1 and EN 50636-2-91.

The measured and guaranteed sound power levels have been determined in accordance with UK regulations Noise Emission in the Environment by Equipment for use Outdoors Regulations 2001, Schedule 9.

Participating notified body: AnP Certification Limited, 2 Parkfield Street, Rusholme, Manchester M 14 4PN

– Measured sound power level: 94 dB(A)  
– Guaranteed sound power level: 96 dB(A)

The technical documentation is stored at ANDREAS STIHL AG & Co. KG.

The year of manufacture, country of manufacture and serial number are specified on the rating plate of the brushcutter.

Waiblingen, 2022-10-15

ANDREAS STIHL AG & Co. KG

pp 

Robert Olma, Vice President, Regulatory Affairs & Global Governmental Relations

## 27 General Power Tool Safety Warnings

### 27.1 Introduction

This chapter reproduces the pre-formulated, general safety precautions specified in the IEC 62841 standard for hand-held motor-operated electric tools.

STIHL is obliged to publish these texts.

The safety precautions and warnings on avoiding an electric shock given under "Electrical Safety" do not apply to STIHL cordless products.

### WARNING

- **Read all safety warnings, instructions, illustrations and specifications provided with this power tool.** Failure to follow all instructions listed below may result in electric shock, fire and/or serious injury. **Save all warnings and instructions for future reference.**

The term "electric power tool" in the safety warnings refers to mains-operated (corded) power tools or battery-operated (cordless) power tools.

### 27.2 Work area safety

- a) **Keep work area clean and well lit.** Cluttered or dark areas invite accidents.
- b) **Do not operate power tools in explosive atmospheres, such as in the presence of flammable liquids, gases or dust.** Power tools create sparks which may ignite the dust or fumes.
- c) **Keep children and bystanders away while operating a power tool.** Distractions can cause you to lose control.

### 27.3 Electrical safety

- a) **Power tool plugs must match the outlet. Never modify the plug in any way. Do not use any adapter plugs with earthed (grounded) power tools.** Unmodified plugs and matching outlets will reduce risk of electric shock.
- b) **Avoid body contact with earthed or grounded surfaces, such as pipes, radiators, ranges and refrigerators.** There is an increased risk of electric shock if your body is earthed or grounded.
- c) **Do not expose power tools to rain or wet conditions.** Water entering a power tool will increase the risk of electric shock.
- d) **Do not abuse the cord. Never use the cord for carrying, pulling or unplugging the power tool. Keep cord away from heat, oil, sharp edges or moving parts.** Damaged or entangled cords increase the risk of electric shock.
- e) **When operating a power tool outdoors, use an extension cord suitable for outdoor use.** Use of a cord suitable for outdoor use reduces the risk of electric shock.
- f) **If operating a power tool in a damp location is unavoidable, use a residual current device (RCD) protected supply.** Use of an RCD reduces the risk of electric shock.

## 27.4 Personal safety

- a) **Stay alert, watch what you are doing and use common sense when operating a power tool. Do not use a power tool while you are tired or under the influence of drugs, alcohol or medication.** A moment of inattention while operating power tools may result in serious personal injury.
- b) **Use personal protective equipment. Always wear eye protection.** Protective equipment such as a dust mask, non-skid safety shoes, hard hat or hearing protection used for appropriate conditions will reduce personal injuries.
- c) **Prevent unintentional starting. Ensure the switch is in the off-position before connecting to power source and/or battery pack, picking up or carrying the tool.** Carrying power tools with your finger on the switch or energising power tools that have the switch on invites accidents.
- d) **Remove any adjusting key or wrench before turning the power tool on.** A wrench or a key left attached to a rotating part of the power tool may result in personal injury.
- e) **Do not overreach. Keep proper footing and balance at all times.** This enables better control of the power tool in unexpected situations.
- f) **Dress properly. Do not wear loose clothing or jewellery. Keep your hair and clothing away from moving parts.** Loose clothes, jewellery or long hair can be caught in moving parts.
- g) **If devices are provided for the connection of dust extraction and collection facilities, ensure these are connected and properly used.** Use of dust collection can reduce dust-related hazards.
- h) **Do not let familiarity gained from frequent use of tools allow you to become complacent and ignore tool safety principles.** A careless action can cause severe injury within a fraction of a second.

## 27.5 Power tool use and care

- a) **Do not force the power tool. Use the correct power tool for your application.** The correct power tool will do the job better and safer at the rate for which it was designed.
- b) **Do not use the power tool if the switch does not turn it on and off.** Any power tool that cannot be controlled with the switch is dangerous and must be repaired.

- c) **Disconnect the plug from the power source and/or remove the battery pack, if detachable, from the power tool before making any adjustments, changing accessories, or storing power tools.** Such preventive safety measures reduce the risk of starting the power tool accidentally.
- d) **Store idle power tools out of the reach of children and do not allow persons unfamiliar with the power tool or these instructions to operate the power tool.** Power tools are dangerous in the hands of untrained users.
- e) **Maintain power tools and accessories. Check for misalignment or binding of moving parts, breakage of parts and any other condition that may affect the power tool's operation. If damaged, have the power tool repaired before use.** Many accidents are caused by poorly maintained power tools.
- f) **Keep cutting tools sharp and clean.** Properly maintained cutting tools with sharp cutting edges are less likely to bind and are easier to control.
- g) **Use the power tool, accessories and tool bits etc. in accordance with these instructions, taking into account the working conditions and the work to be performed.** Use of the power tool for operations different from those intended could result in a hazardous situation.
- h) **Keep handles and grasping surfaces dry, clean and free from oil and grease.** Slippery handles and grasping surfaces do not allow for safe handling and control of the tool in unexpected situations.

## 27.6 Battery tool use and care

- a) **Recharge only with the charger specified by the manufacturer.** A charger that is suitable for one type of battery pack may create a risk of fire when used with another battery pack.
- b) **Use power tools only with specifically designed battery packs.** Use of any other battery packs may create a risk of injury and fire.
- c) **When battery pack is not in use, keep it away from other metal objects, like paper clips, coins, keys, nails, screws or other small metal objects, that can make a connection from one terminal to another.** Shorting the battery terminals together may cause burns or a fire.
- d) **Under abusive conditions, liquid may be ejected from the battery; avoid contact. If**



- contact accidentally occurs, flush with water. If liquid contacts eyes, additionally seek medical help.** Liquid ejected from the battery may cause irritation or burns.
- e) **Do not use a battery pack or tool that is damaged or modified.** Damaged or modified batteries may exhibit unpredictable behaviour resulting in fire, explosion or risk of injury.
  - f) **Do not expose a battery pack or tool to fire or excessive temperature.** Exposure to fire or temperature above 130 °C may cause explosion.
  - g) **Follow all charging instructions and do not charge the battery pack or tool outside the temperature range specified in the instructions.** Charging improperly or at temperatures outside the specified range may damage the battery and increase the risk of fire.

## 27.7 Service

- a) **Have your power tool serviced by a qualified repair person using only identical replacement parts.** This will ensure that the safety of the power tool is maintained.
- b) **Never service damaged battery packs.** Service of battery packs should only be performed by the manufacturer or authorized service providers.

## 27.8 Grass Trimmer, Brush Cutter and Brush Saw Safety Warnings

- a) **Do not use the machine in bad weather conditions, especially when there is a risk of lightning.** This increases the risk of being struck by lightning.
- b) **Thoroughly inspect the area for wildlife where the machine is to be used.** Wildlife may be injured by the machine during operation.
- c) **Thoroughly inspect the area where the machine is to be used and remove all stones, sticks, wires, bones, and other foreign objects.** Thrown objects can cause personal injury.
- d) **Before using the machine, always visually inspect to see that the cutter or blade and the cutter or blade assembly are not damaged.** Damaged parts increase the risk of injury.
- e) **Follow instructions for changing accessories.** Improperly tightened blade security nuts or

bolts may either damage the blade or result in it becoming detached.

- f) **The rated rotational speed of the blade must be at least equal to the maximum rotational speed marked on the machine.** Blades running faster than their rated rotational speed can break and fly apart.
- g) **Wear eye, ear, head and hand protection.** Adequate protective equipment will reduce personal injury by flying debris or accidental contact with the cutting line or blade.
- h) **While operating the machine, always wear non-slip and protective footwear. Do not operate the machine when barefoot or wearing open sandals.** This reduces the chance of injury to the feet from contact with the moving cutters or lines.
- i) **While operating the machine, always wear safety footwear. Do not operate the machine when barefoot or wearing open sandals.** This reduces the chance of injury to the feet from contact with a moving cutter, line or blade.
- j) **While operating the machine, always wear long trousers.** Exposed skin increases the likelihood of injury from thrown objects.
- k) **Keep bystanders away while operating the machine.** Thrown debris can result in serious personal injury.
- l) **Always use two hands when operating the machine.** Holding the machine with both hands will avoid loss of control.
- m) **Hold the machine by insulated gripping surfaces only, because the cutting line or blade may contact hidden wiring or its own cord.** Cutting line or blades contacting a "live" wire may make exposed metal parts of the machine "live" and could give the operator an electric shock.
- n) **Always keep proper footing and operate the machine only when standing on the ground.** Slippery or unstable surfaces may cause a loss of balance or control of the machine.
- o) **Do not operate the machine on excessively steep slopes.** This reduces the risk of loss of control, slipping and falling which may result in personal injury.
- p) **When working on slopes, always be sure of your footing, always work across the face of slopes, never up or down and exercise extreme caution when changing direction.** This reduces the risk of loss of control, slip-

- ping and falling which may result in personal injury.
- q) **Keep all parts of the body away from the cutter, line or blade when the machine is operating. Before you start the machine, make sure the cutter, line or blade is not contacting anything.** A moment of inattention while operating the machine may result in injury to yourself or others.
  - r) **Do not operate the machine above waist height.** This helps prevent unintended cutter or blade contact and enables better control of the machine in unexpected situations.
  - s) **When cutting brush or saplings that are under tension, be alert for spring back.** When the tension in the wood fibres is released, the brush or sapling may strike the operator and/or throw the machine out of control.
  - t) **Use extreme caution when cutting brush and saplings.** The slender material may catch the blade and be whipped toward you or pull you off balance.
  - u) **Maintain control of the machine and do not touch cutters, lines or blades and other hazardous moving parts while they are still in motion.** This reduces the risk of injury from moving parts.
  - v) **Carry the machine with the machine switched off and away from your body.** Proper handling of the machine will reduce the likelihood of accidental contact with a moving cutter, line or blade.
  - w) **When transporting or storing the machine, always fit the cover on metal blades.** Proper handling of the machine will reduce the likelihood of accidental contact with the blade.
  - x) **Only use replacement cutters, lines, cutting heads and blades specified by the manufacturer.** Incorrect replacement parts may increase the risk of breakage and injury.
  - y) **When clearing jammed material or servicing the machine, make sure the switch is off and the battery pack is removed.** Unexpected starting of the machine while clearing jammed material or servicing may result in serious personal injury.
- be violent enough to cause the machine and/or operator to be propelled in any direction, and possibly lose control of the machine.
- Blade thrust and its related hazards can be avoided by taking proper precautions as given below.
- a) **Maintain a firm grip with both hands on the machine and position your arms to resist blade thrust. Position your body to the left side of the machine.** Blade thrust can increase the risk of injury due to the machine moving unexpectedly. Blade thrust can be controlled by the operator if proper precautions are taken.
  - b) **If the blade binds, or when interrupting a cut for any reason, switch the machine off and hold the machine motionless in the material until the blade comes to a complete stop. While the blade is binding, never attempt to remove the machine from the material or pull the machine backward while the blade is in motion, otherwise blade thrust may occur.** Investigate and take corrective actions to eliminate the cause of blade binding.
  - c) **Thoroughly inspect the area where the machine is to be used and remove all stones, sticks, wires, bones, and other foreign objects.** Blunt or damaged blades increase the risk of jamming or catching on an object, resulting in blade thrust.
  - d) **Always maintain good visibility of the material being cut.** Blade thrust is more likely to occur in areas where it is difficult to see the material being cut.
  - e) **If you are approached by another person while operating the machine, switch the machine off.** There is an increased risk of injury to other persons being struck by the moving blade in the event of blade thrust.

## 27.9 Blade thrust related warnings

Blade thrust is a sudden sideways, forward or backward motion of the machine, which may occur when the blade jams or catches on an object such as a sapling or a tree stump. It can



[www.stihl.com](http://www.stihl.com)



0458-029-0101-A



0458-029-0101-A