

Select Proper Backset

For use on doors 1-3/8" to 1-3/4" (35mm - 45mm)
Backset is distance from door edge to center of hole on door face.

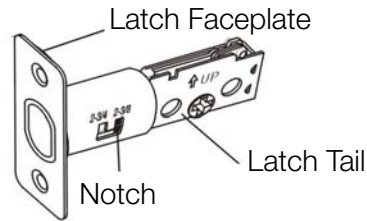
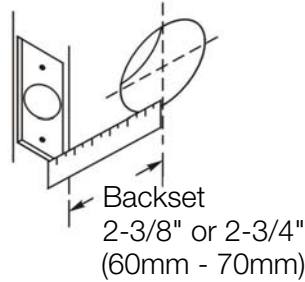

To adjust backset from 2-3/8" to 2-3/4"

Retract latchbolt.	Hold latch tail and rotate faceplate clockwise.	Once notch is in groove, pull latch faceplate away from latch tail.	Rotate latch faceplate counter clockwise and check that notch is at 2-3/4" mark.

To adjust backset from 2-3/4" to 2-3/8"

Retract latchbolt.	Hold latch tail and rotate faceplate clockwise.	Once notch is in groove, push latch faceplate towards latch tail.	Rotate latch faceplate counter clockwise and check that notch is at 2-3/8" mark.

Template

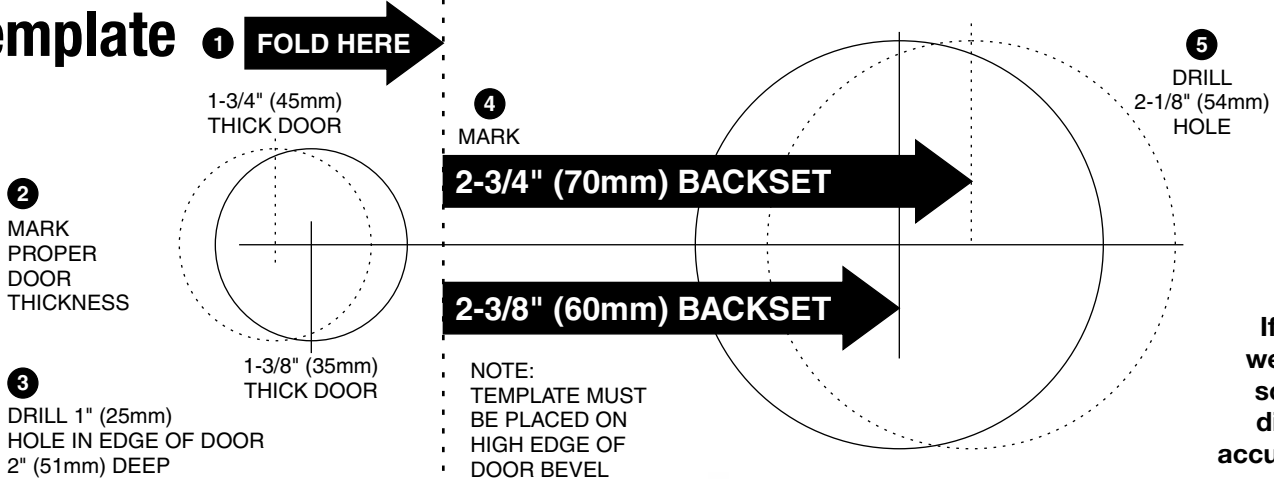

CAUTION:
If printed from website print 1:1 scale. Measure dimensions for accuracy before use.

1

Mark Door



Fold and apply template to high edge of door bevel and mark center of door edge as indicated on template at desired height from floor.

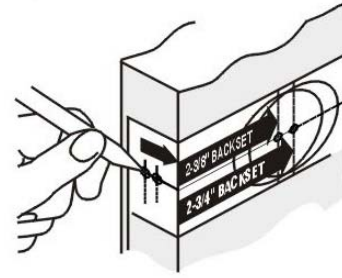

Mark center hole on door face through guide on template for either 2-3/8" (60mm) or 2-3/4" (70mm) backset.

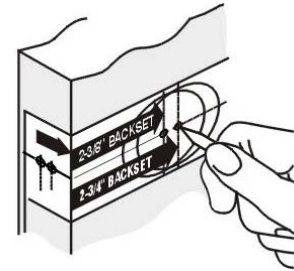

2

Drill Holes



Drill through door face as marked for deadlock.

Note: Drill holes from both sides to prevent splitting.

Hole size is 2-1/8" (54mm) for standard installations.

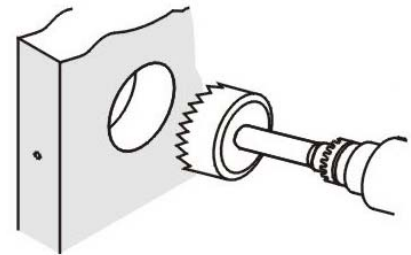

Drill 1" (25mm) hole in center of door edge through to 2-1/8" (54mm) hole for latch.

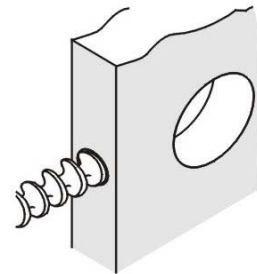

3

Install Deadbolt Latch

Insert deadbolt latch in hole keeping it parallel to face of door and in UP position as indicated on latch.

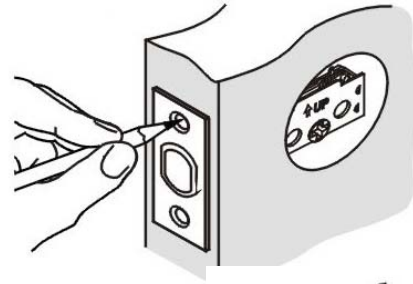

Mark outline and remove latch.

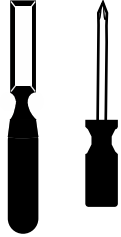

Chisel 1/8" (3.2mm) deep or until latch face is flush with door edge.

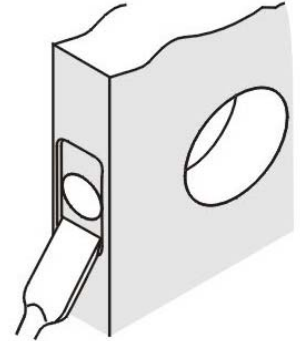

Insert deadbolt latch in hole keeping it parallel to face of door and in UP position as indicated on latch..



Mark two (2) fastener holes, remove latch and drill pilot holes with 1/16" (1.6mm) drill bit.

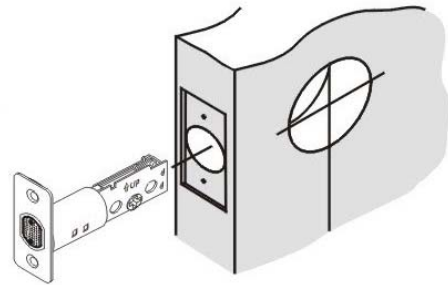

Using provided screws, install deadbolt latch in UP position as indicated on latch.

4

Install Strike

Locate strike to align with deadbolt in door.

Mark outline of strike and deadbolt hole.



Bore 1" (25mm) hole 1" (25mm) minimum deep into frame.

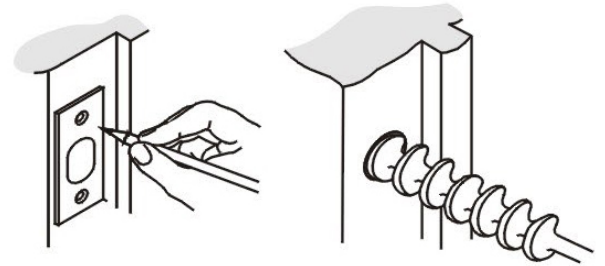
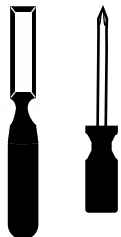

Mortise 1/16" (1.6mm) deep.

Using provided screws, install strike.

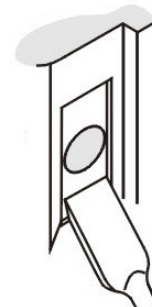

5

Install Exterior Cylinder

Press cylinder flush against door making certain the torque blade is properly positioned in latch crank.

Tapped holes in mounting plate of exterior cylinder should be aligned with latch holes.

Key hole should be in down position.

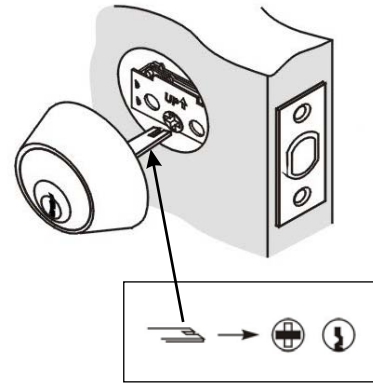

Torque blade inserted horizontally into latch crank.
Key hole in down position.

6

Install Interior Mechanism

Slide interior turn piece onto exterior cylinder torque blade.



Insert machine screws through holes engaging holes in cylinder and tighten.

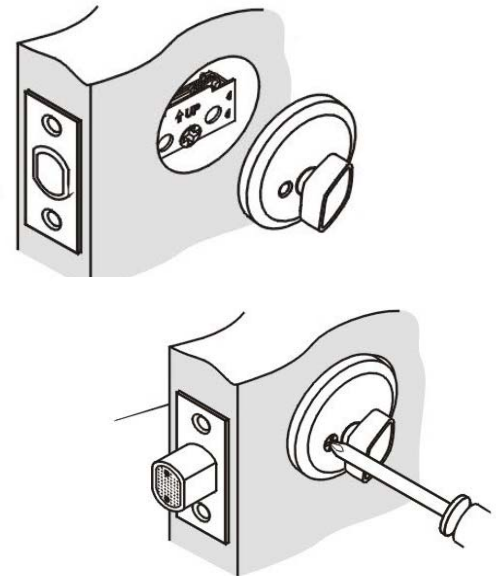

Yale Locks & Hardware

Product Support Tel 1-855-213-5841 • www.yalehome.com

Yale® and Yale Edge Series® are registered trademarks of Assa Abloy Residential Group. Other products' brand names may be trademarks or registered trademarks of their respective owners and are mentioned for reference purposes only.

© Copyright 2018. All rights reserved. Reproduction in whole or in part without the express written permission of Assa Abloy Residential Group is prohibited.