



# Cylinder Head Temperature Instructions (2-1/16" • 2-5/8") (Settable Warning Light - Optional Feature)

# **SPEEDHUT**

## INSTALLATION

- 1 DISCONNECT your vehicle's negative (-) battery cable.
- 2 MOUNT your gauge to the panel using the spin lock ring.
- 3 CONNECT the gauge wiring.
- 4 RECONNECT your vehicle's negative (-) battery cable.

BACK OF GAUGE

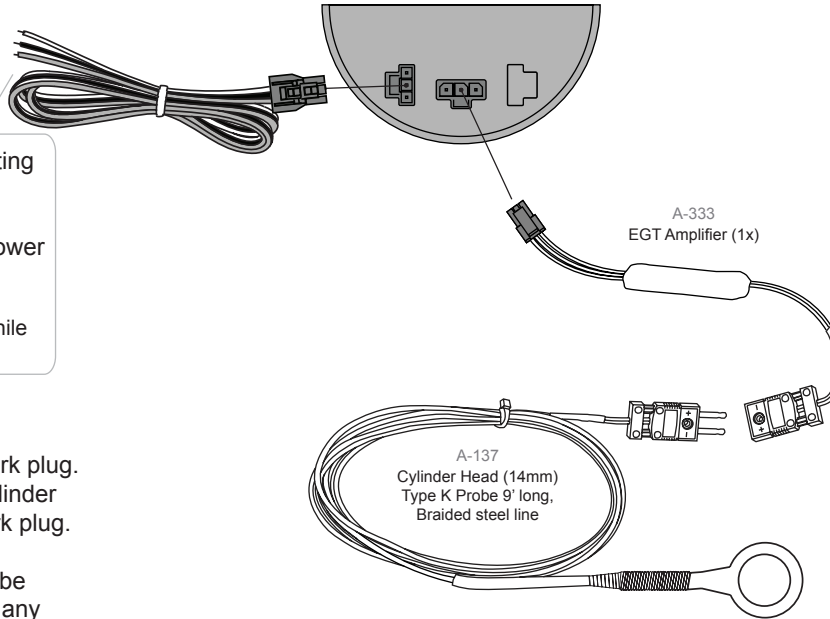

WHITE: +12v Dash Lighting  
(Gauge lighting)  
BLACK: Ground  
RED: +12v Accessory Power  
(Main Gauge Power)

\*Should **NOT** see power while engine is cranking

- 1 REMOVE spark plug
- 2 PLACE probe under spark plug. Make sure sits flat on cylinder head. Re-install the spark plug.
- 3 PROPER position of probe should not interfere with any other components.
- 4 TIGHTEN spark plug to manufacturers specification.

**ATTENTION: DO NOT CUT OR MODIFY PROBE LENGTH.** Any length modification will affect gauge calibration and readings. If there is excess wire, coil and loosely tie under hood.

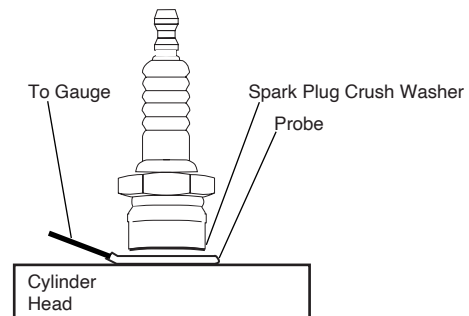

## SETTING WARNING LIGHT (Optional Feature)

The warning LED can be set to turn on for a low and/or high condition. Setting will be retained even when powered off.

- 1 With NO power to the gauge, PRESS and HOLD the button.
- 2 While HOLDING the button, power the gauge on. When the warning light turns on, release the button. Pointer will slowly move clockwise from gauge min. value.
- 3 PRESS the button at desired low warning set point. LED light will BLINK to indicate low warning has been set. (Pressing button at min. value will turn low LED warning OFF.)

Pointer will now slowly move counter-clockwise from gauge max value.

- 4 PRESS button at desired high warning set point. LED light will BLINK to indicate high warning has been set. (Pressing button at max. value will turn high LED warning OFF.)

## SETTING LED BRIGHTNESS (Optional Feature)

**ATTENTION:** 1) Setting LED brightness while gauge lighting is OFF will set DAY LED brightness. 2) Setting LED brightness while gauge lighting is ON will set NIGHT LED brightness.

- 1 POWER gauge ON.
- 2 QUICK PRESS the button. LED will light up at current brightness setting.
- 3 PRESS the button to toggle through LED brightness options. After a small delay, LED light will BLINK to indicate setting has been saved.

(Off) 0 - 1 - 2 - 3 - 4 (Most Bright)

## PEAK RECALL MEMORY (Optional Feature)

- 1 POWER gauge ON.
- 2 PRESS AND HOLD button. Pointer will move to high peak and remain there until button is released.
- 3 To RETAIN peak reading, release button and wait 5 sec. Gauge will return to normal and retain reading.
- 4 To CLEAR peak reading, release button and press again within 5 sec. LED will flash twice and pointer will travel to zero to indicate peak has been cleared.

### LIFETIME WARRANTY

We take pride in the products we make and offer a Lifetime Warranty on gauge electronics and a 5-year warranty on hardware for every gauge, tachometer and shift light purchased since Jan 1, 2006. Every SPEEDHUT product is built for a lifetime of service, and we warrant to the person who originally purchased the product that all SPEEDHUT products will be free from defects in workmanship and materials for their applicable warranty period. If a defect occurs during the warranty period as the result of the product's intended use, we will repair or replace the defective product or part, to our discretion. The warranty does not cover defects caused by third-party modifications, repairs or replacement parts. Any holes, scratches, normal wear and tear, and the natural breakdown of colors and materials over extended time and use are not warranted.

### CONTACT US

Support@Speedhut.com  
801-221-1460 (9a-4p MST)  
FAQ - Speedhut.com/faq.i  
www.Speedhut.com