

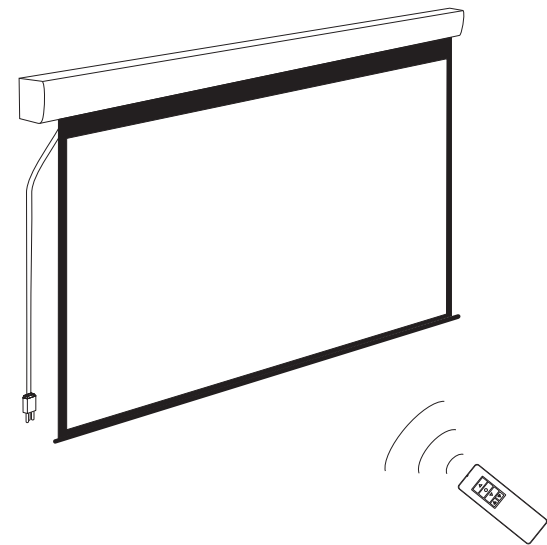

Instruction Manual for Remote Synchro Motor Electric Projection Screen



Thank you for purchasing a sapphire projection screen.
Before use, please read instructions carefully. After installation, store instructions for future reference.

Technical Assistance

If you need help with installing this screen please visit
www.sapphireav.com



Description

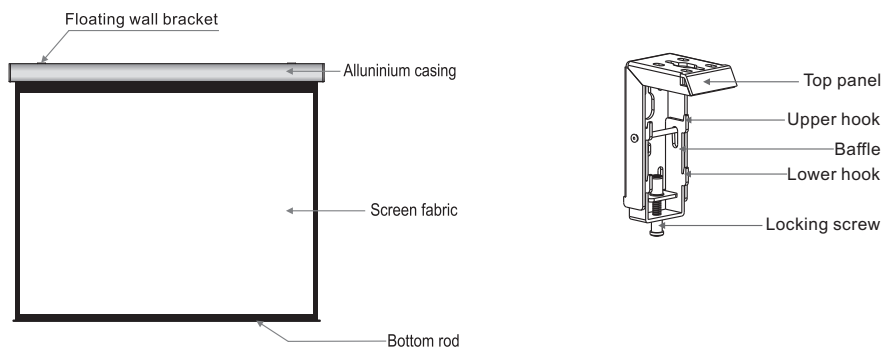

Accessories

- Floating wall bracket(2pcs)
- $\phi 5 \times 40$ mm Tapping screw & cap (8 sets)
- Hanging bracket (2pcs)

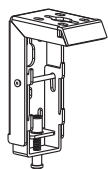

- M5x10 Screw (6pcs)



- Allen key (1pc)



- External IR Receiver (1pc)
- Instruction manual (1pc)



Motorized Screen Power Specifications

Voltage	Frequency	Watts	Application
230V/120V/100V	50Hz/60Hz	90W/80W	Applies up to 120" motorized screens

To avoid overheating the motor, do not continually retract and lower the screen for over 4 minutes at a time. If the motor overheats, it will need a cool down time of 2 minutes. The motor does not need any lubricants. The drop and retract limit of the screen is factory preset to an optimal configuration. Please ask your local dealer or professional to adjust settings to avoid damaging the motor.

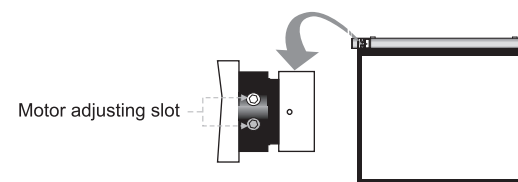

Warnings

- Always ensure that there is solid wood, concrete, metal or a solid wall to fix to. Never use just plasterboard and ensure that you test the fixings carefully before hanging the screen.
- When you offer up the screen ensure that you have it locked into the bracket securely at both ends.
IF YOU HAVE ANY CONCERNS ABOUT THE STABILITY OF THE BRACKET FIXINGS DO NOT HANG THE SCREEN TAKE PROFESSIONAL ADVICE FROM A BUILDING SURVEYOR OR OTHER PROFESSIONAL INSTALLER.
- While installing electrical motors, please hire professionals or your local dealer to ensure safety.
- Please read the following as any damage to the screen surface will affect the quality of the picture:
 - 1.Avoid contact or touching the screen surface as it may cause scratches or tears.
 - 2.Do not write or draw on the surface
 - 3.Clean the screen with a soft cloth and lukewarm water . Do not use any detergent or cleaning products.
- Roll up the screen after every use. Ensure that the screen is level when installing ;do not pull on the sides or fold the screen.
- To prevent damage , the operating and maintenance of the screen should be done by adults.



Ignoring the safety warnings may lead to injuries and/or damaging the product.



Fixtures should be installed in a secure manner to avoid accidents or the screen falling.



Do not connect any electrical attachments or remote controls.



Roll up the screen after every use. Leaving it hanging for a long period of time may cause the fabric to stretch.



Please contact your local dealer for repairs or maintenance. Avoid taking apart the screen or the warrants will be void.



Refrain from hanging anything on the screen as it may cause the screen to fall.

Product specifications are subject to change.

Instructions

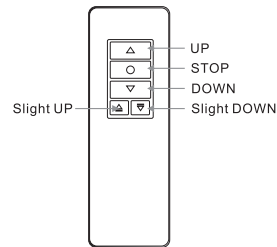

Front view

Remote Controller Instruction

1. To retract screen, press "UP".
2. To stop screen, press "STOP".
3. To lower screen down, press "DOWN".
4. To retract screen slightly, press "Slight UP".
5. To lower screen down slightly, press "Slight DOWN".

Remote controller guideline:

1. Working temperature: -20°C - +80°C.
2. Protection index: IP30.
3. Batteries: 1.5V x 2pcs, model # AAA.
4. Working under normal polluted environment.
5. Take out batteries if the controller will not be used for a long time.
6. Please change the batteries when signal is weak.

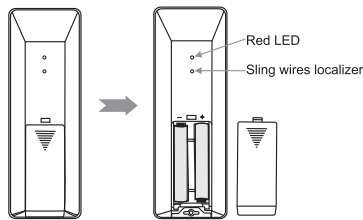

Back view

How to install the batteries:

Please change the batteries as below when signal is weak.

1. Turn around the controller, push to pen the cover as guiding arrow.
2. Put the batteries in according to the guide of anode and cathode.
3. Close the cover.

Caution

The controller does not work if mistaking the anode and cathode of batteries, please correct the direction according to the figure on the left.

Spare outside receiver

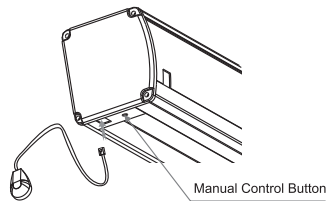

For hidden installation, plug the outside receiver in according to the drawing.

Manual Control Button

The button could control the screen manually and be effective repeatedly.

Installation

Take out all the parts from the packaging and follow the accessagires guideline to ensure you have all parts.

There are three installation measures for this product, namely wall mounting, ceiling mounting and ceiling hang. The installed distance can be changeable up to your needs via adjusting the slipper block, while the ideal position is the mounting bracket is at its nearest point to the endcap, which can reduce unnecessary vibration or noise.

Floating wall bracket installation

1. Choose screws for mounting according to wall material. (Tips: Wood screws for wood wall, and Tapping screws for concrete wall.)
2. Mount the brackets onto the wall, assuring they are at the horizontal level. (Tips: draw an erasable level line when mounting the brackets) (Figure 1) Here below are the details:

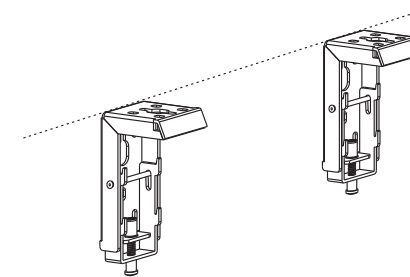

Figure 1

Installation Steps

- a) Wood wall and ceiling installation: Drill in the 5 x 40 screws through the appropriate holes in the bracket (Figure 2-3).
- b) Drywall and ceiling installation: Install the anchors and drill in the 5 x 40 screws into the appropriate bracket holes. (Figure 4-5).

Wood wall installation

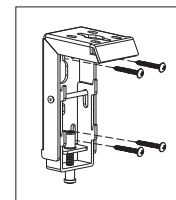

Figure 2

Wood ceiling installation

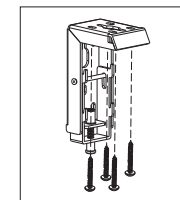

Figure 3

Concrete wall installation

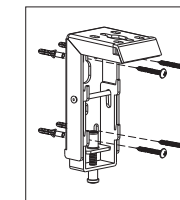

Figure 4

Concrete ceiling installation

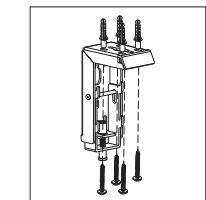
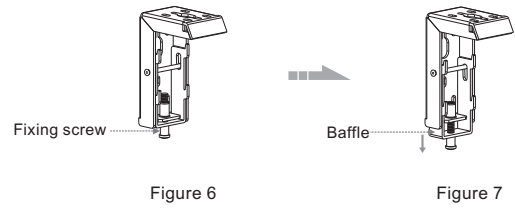
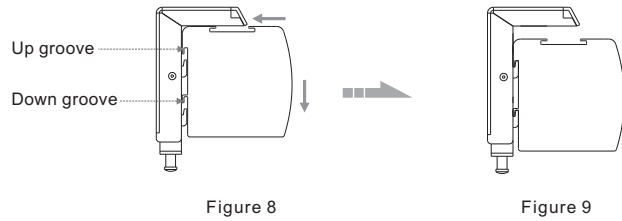

Figure 5

3. Loosen the locking screw to lower the bracket clamp all the way down. (Figure 6-7)



4. Mount the projection screen by sliding the casing grooves over the bracket hooks. (Figure 8-9)



5. Tighten the locking screw to clamp the screen securely in place.) Figure 10-11 (

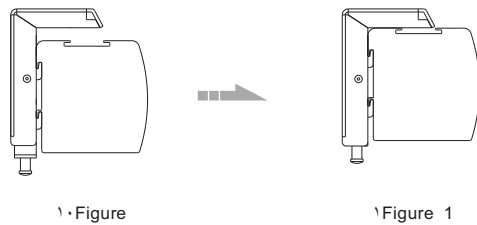

Ceiling hang installation

Each end of the screen casing needs to be supported by a hook (not provided). Ensure that the suspension system (cable and/or hook) can support the weight of the screen.

1. To drill two same holes with an electric drill horizontally with wall, then fasten hangers (unprovided) onto the ceiling. (Figure 12)

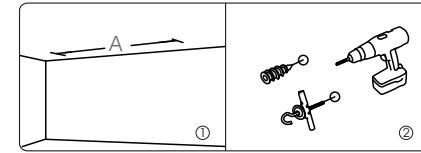
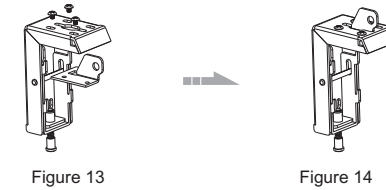
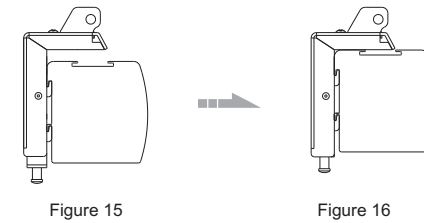

Figure 12

2. Use three M5x10mm screws to fasten the hanging brackets, to the wall and ceiling brackets as shown. (Figure 13-14)



3. Attach the wall and ceiling brackets to the casing as shown in figures 15 and 16.



4. Place hooks through the hanging brackets to suspend the projection screen as shown. See figure 17.

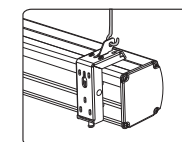

Figure 17