

---

# INSTALLATION INSTRUCTIONS

---

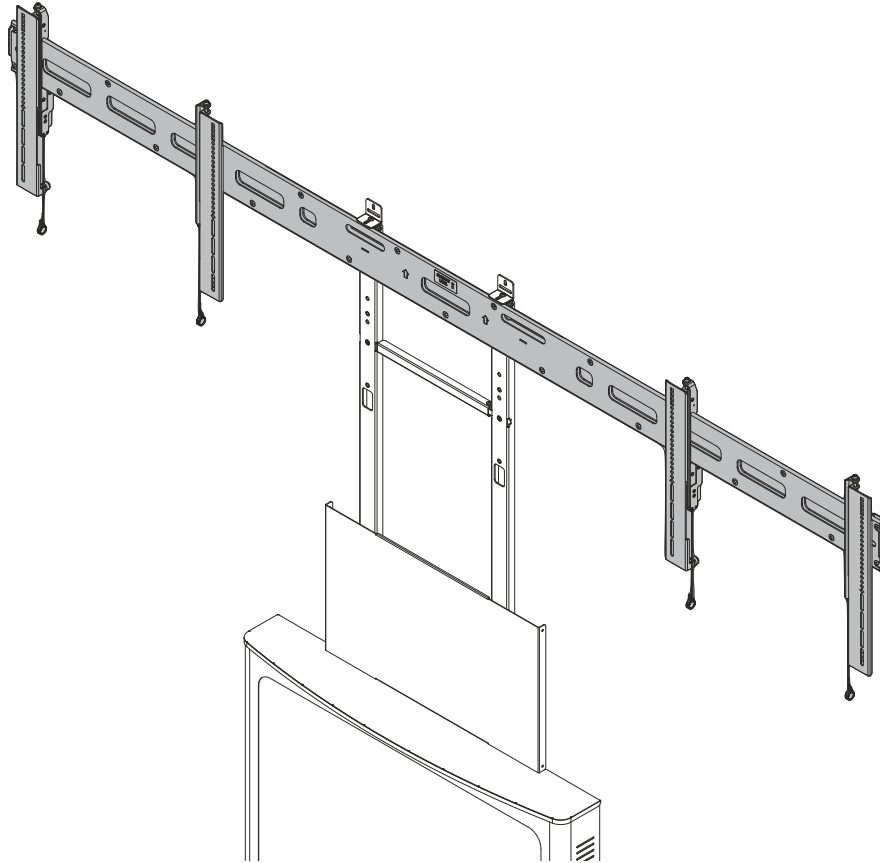

---

## X-Large AVSFSS Tempo™ 2x1 Accessory

---

## DISCLAIMER

Legrand | AV and its affiliated corporations and subsidiaries (collectively "Legrand | AV"), intend to make this manual accurate and complete. However, Legrand | AV makes no claim that the information contained herein covers all details, conditions or variations, nor does it provide for every possible contingency in connection with the installation or use of this product. The information contained in this document is subject to change without notice or obligation of any kind. Legrand | AV makes no representation of warranty, expressed or implied, regarding the information contained herein. Legrand | AV assumes no responsibility for accuracy, completeness or sufficiency of the information contained in this document.

Chief® and Tempo™ are registered trademarks of Legrand AV Inc.

## DEFINITIONS

**MOUNTING SYSTEM:** A MOUNTING SYSTEM is the primary Chief product to which an accessory and/or component and/or another mounting system is attached.

**ACCESSORY:** AN ACCESSORY is the secondary Chief product which is attached to a primary Chief product, and may have a component attached or setting on it.

**COMPONENT:** A COMPONENT is an audiovisual item designed to be attached or resting on an accessory or mounting system such as a video camera, CPU, screen, display, projector, etc.



**WARNING:** A WARNING alerts you to the possibility of serious injury or death if you do not follow the instructions.



**CAUTION:** A CAUTION alerts you to the possibility of damage or destruction of equipment if you do not follow the corresponding instructions.



## IMPORTANT SAFETY INSTRUCTIONS



**WARNING:** Failure to read, thoroughly understand, and follow all instructions can result in serious personal injury, damage to equipment, or voiding of factory warranty! It is the installer's responsibility to make sure all mounting systems are properly assembled and installed using the instructions provided.



**WARNING:** Failure to provide adequate structural strength for this accessory can result in serious personal injury or damage to equipment! It is the installer's responsibility to make sure the structure to which this accessory is attached or resting on can support five times the combined weight of all equipment. Reinforce the structure as required before installing the accessory. Do not install drywall anchors into the seam between drywall pieces.



**WARNING:** Use this accessory only for its intended use as described in these instructions. Do not use attachments not recommended by the manufacturer.



**WARNING:** Exceeding the weight capacity can result in serious personal injury or damage to equipment! It is the installer's responsibility to make sure the combined weight of all components and accessories attached to each side of the AVA1104 accessory cross bracket does not exceed 100 lbs (45.3 kg) per display or 200 lbs (90.6 kg) for the entire accessory. See figure below.

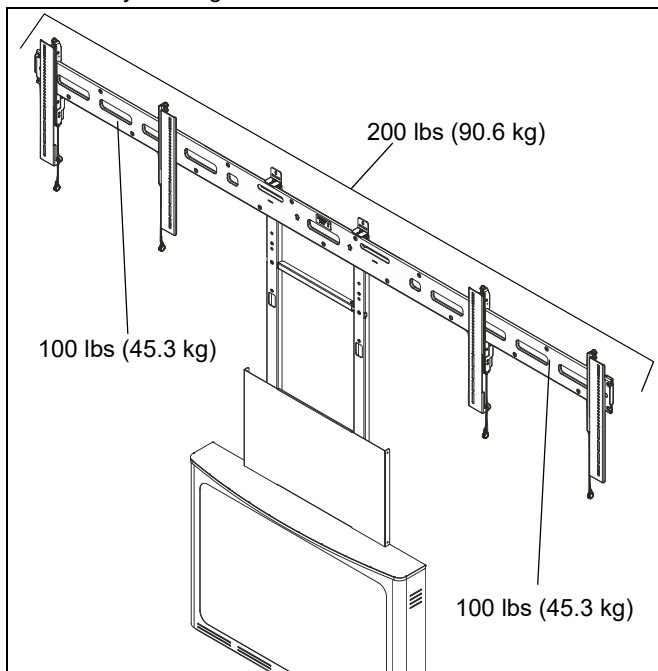

**WARNING:** Never operate this accessory if it is damaged. Return the accessory to a service center for examination and repair.



**WARNING:** Do not use this accessory outdoors.

**IMPORTANT ! :** The AVA1104 accessory is designed to be mounted to one of the following:

- a sheetrock drywall with a thickness of 1/2" to 5/8" supported by 16" or 24" wood or steel studs; or
- a bare concrete wall with a minimum thickness of 8" (203mm); or
- a bare 8" x 8" x 16" (203mm x 203mm x 406mm) concrete block wall;

**IMPORTANT ! :** The AVA1104 accessory needs to be attached to a sheetrock drywall which is supported by 16" or 24" wood or steel studs, however it does NOT need to be attached to these studs directly.

**--SAVE THESE INSTRUCTIONS--**

## DIMENSIONS

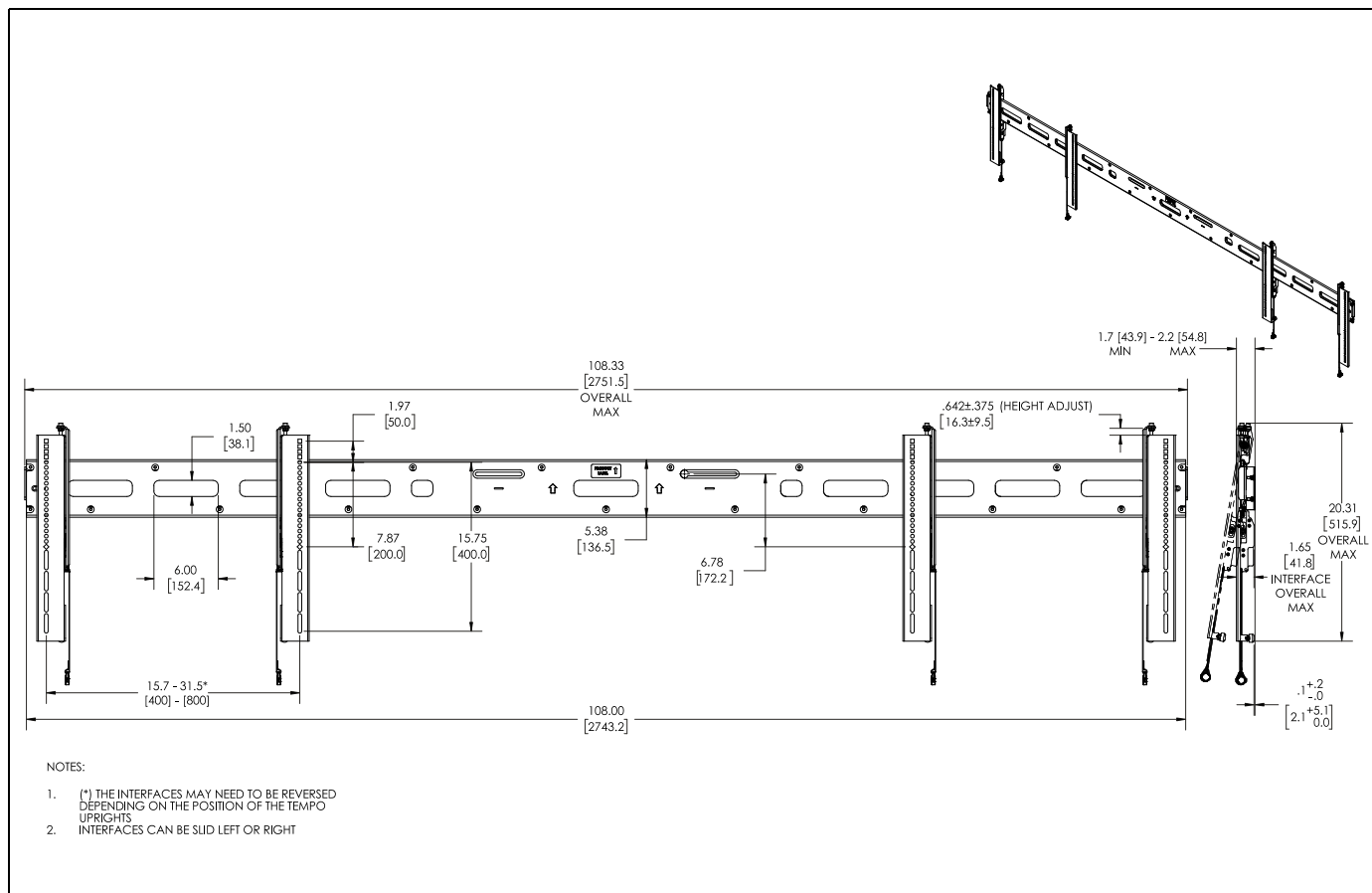

TOOLS REQUIRED FOR INSTALLATION

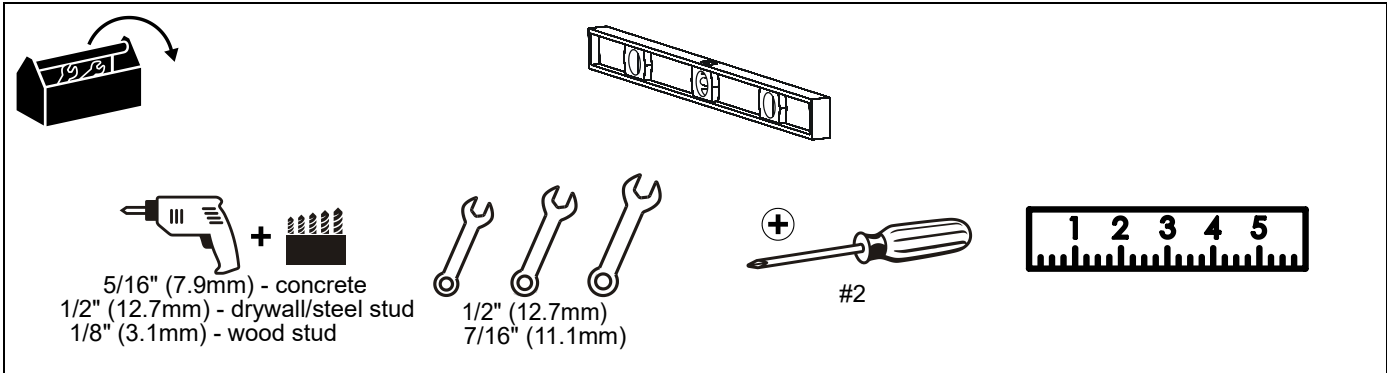

PARTS

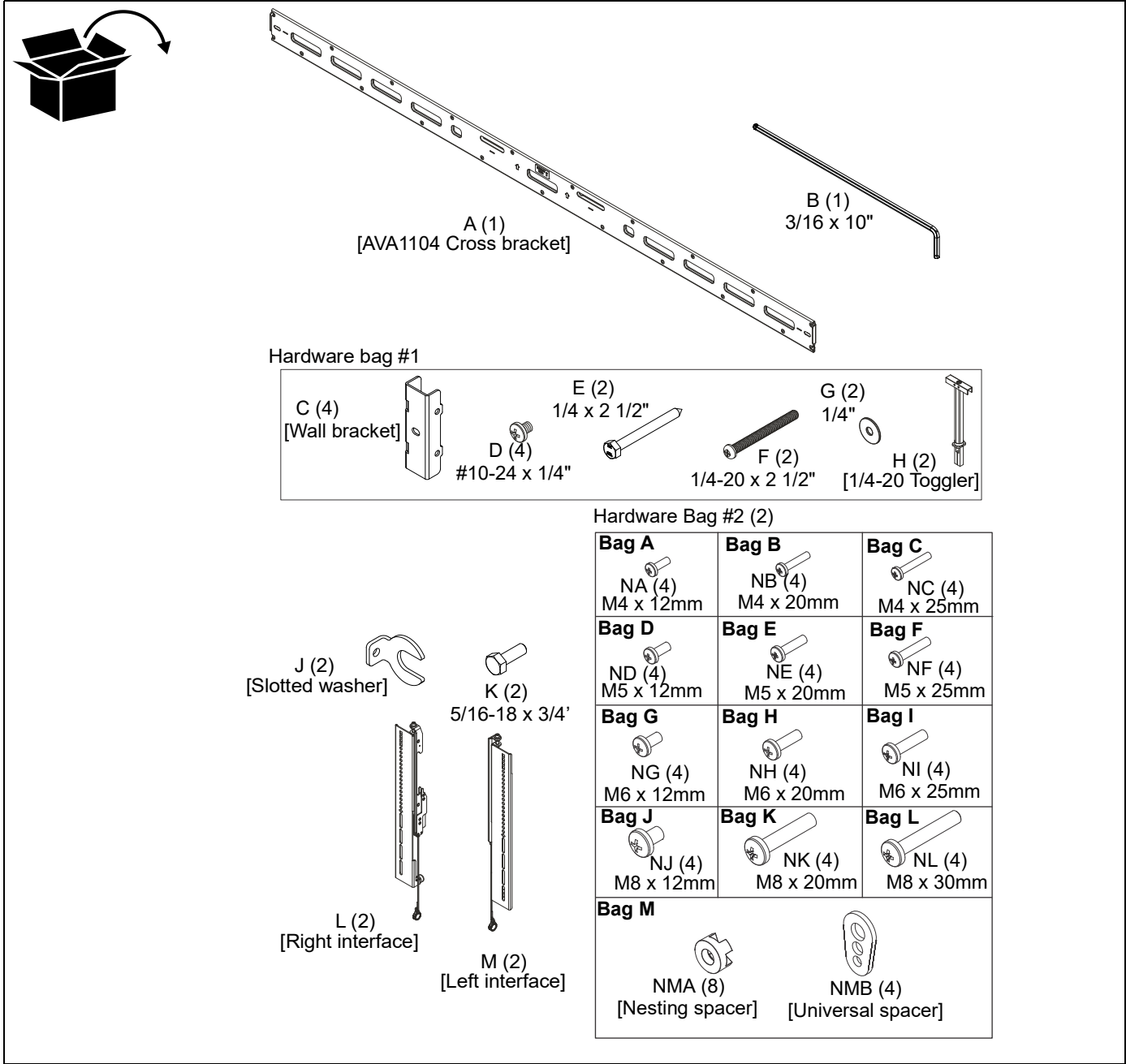

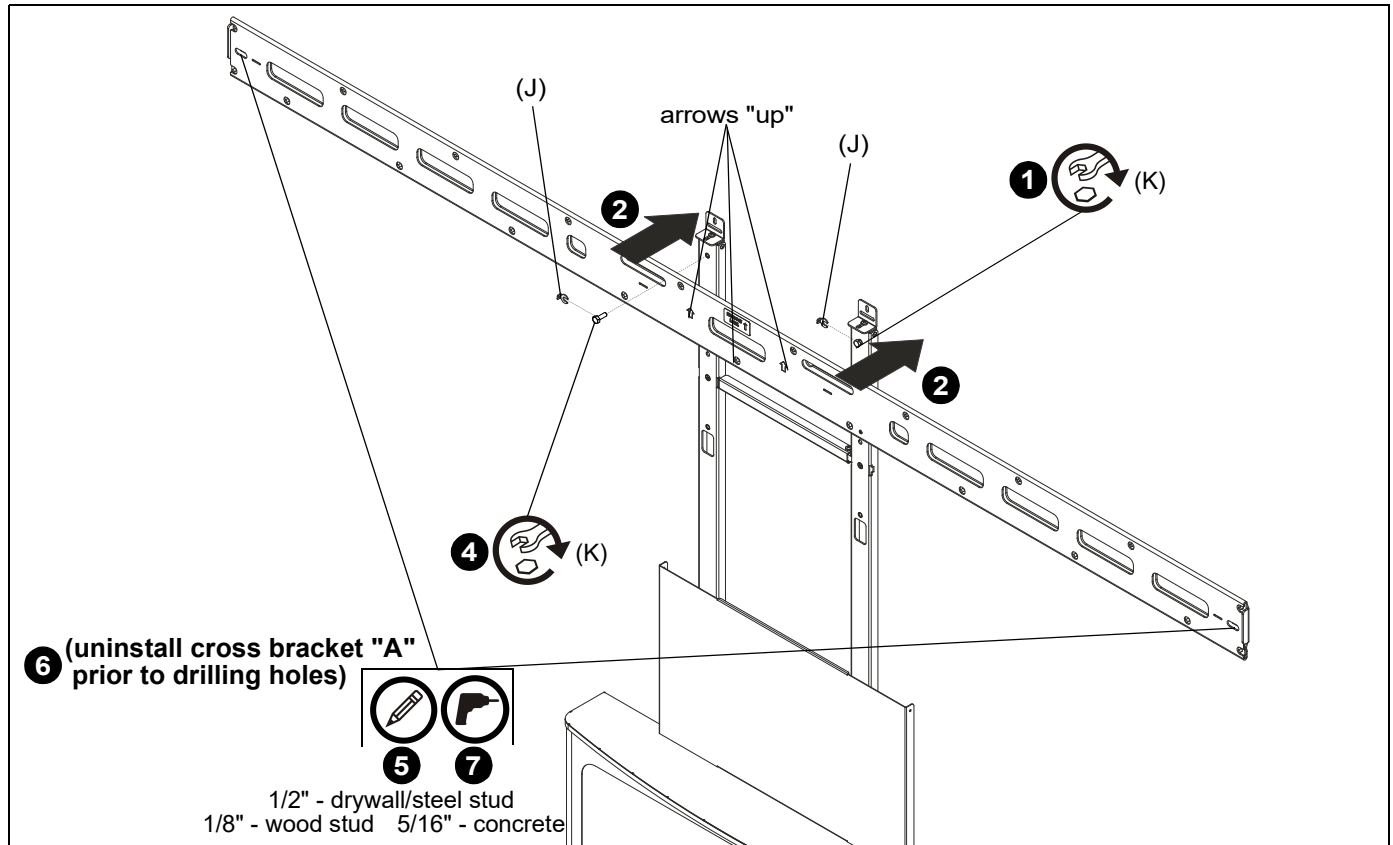

Figure 1

## Assembly And Installation

### Cross Bracket Installation

**IMPORTANT !** : AVSFSS mounting system must be fully assembled and mounted to wall before installing AVA1104 accessory to it.

1. Loosely install one 5/16-18 x 3/4" hex head cap screw (K) with one slotted washer (J) into the right hole on AVSFSS upright. (See Figure 1)
2. Install AVA1101 cross bracket (A) onto loosely installed screw. (See Figure 1) and (See Figure 2)

**NOTE:** Make sure arrows are pointing "up" on cross bracket. (See Figure 1)

3. Slide cross bracket (A) over to left to mounting position. (See Figure 2)

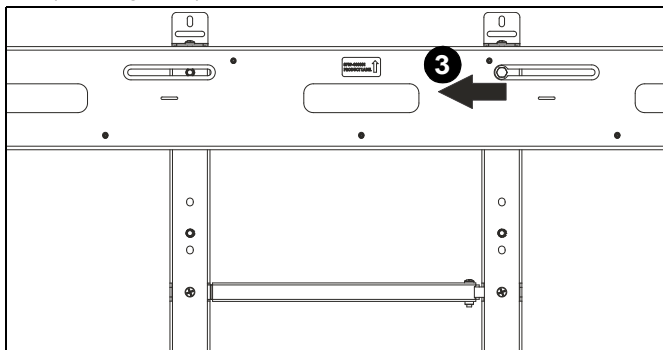

Figure 2

4. Use one 5/16-18 x 3/4" hex head cap screw (K) with one slotted washer (J) to secure cross bracket (A) to the left AVSFSS upright. Do not tighten. (See Figure 1)
5. Mark holes on wall at the locations of the outermost slots of the cross bracket (A). (See Figure 1)
6. Uninstall cross bracket from AVSFSS uprights by following Steps 2-4 in reverse order.
7. Drill two holes at marked locations.
  - For drywall/steel stud only, hole size will be 1/2".
  - For wood studs, hole size will be 1/8".
  - For concrete, hole size will be 5/16".

**NOTE:** If installing to wood studs, proceed to Step 13.

**NOTE:** If one hole is in drywall and the other hole is in a wood stud, follow specific instructions for each hole separately.

8. (Drywall/steel stud only) Hold metal channel on anchor (H) flat alongside plastic straps and slide channel through hole. (See Figure 3)

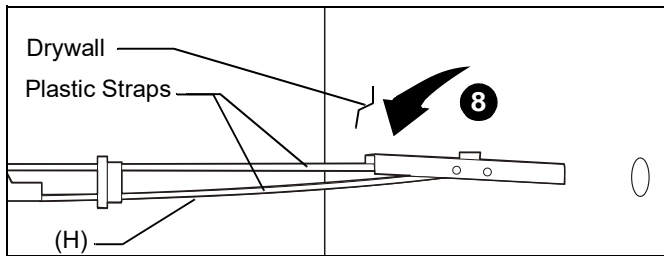

Figure 3

9. (Drywall/steel stud only) Holding plastic straps on anchor (H), pull anchor away from wall until channel rests flush behind wall making sure anchor channel is positioned vertically on stud. (See Figure 4)

10. (Drywall/steel stud only) Slide plastic cap on anchor (H) towards wall until flange of cap is flush with wall. (See Figure 4)

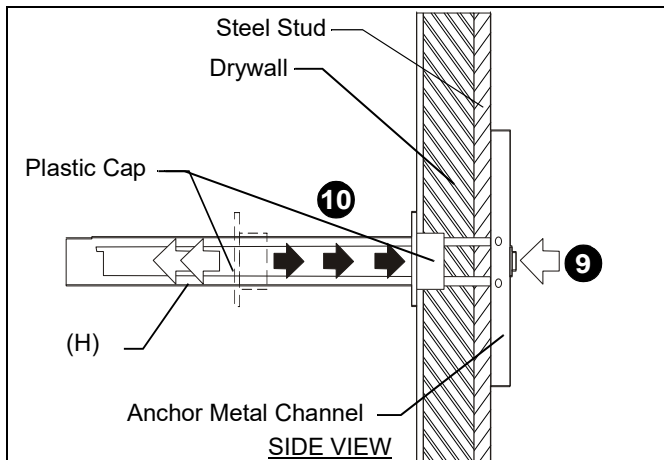

Figure 4

11. (Drywall/steel stud only) Snap off plastic straps on anchor at wall by pushing side to side, snapping off straps level with flange of plastic cap. (See Figure 5)

12. (Drywall/steel stud only) Repeat Steps 8 through 11 for the other mounting hole.

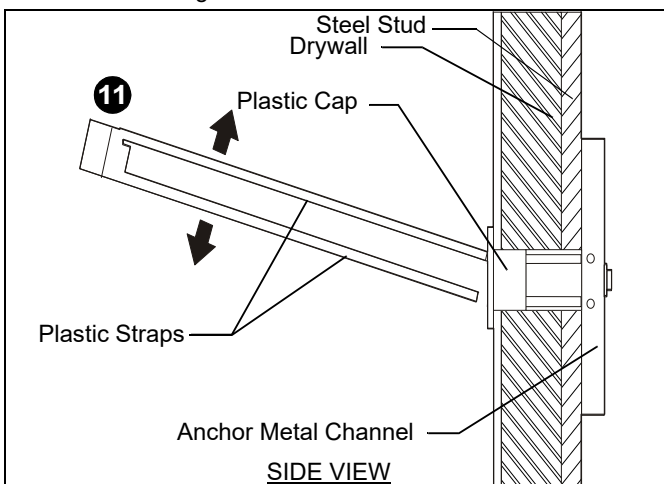

Figure 5

13. Reinstall cross bracket (A) to uprights following Steps 1-4. (See Figure 1) Tighten 5/16-18 x 3/4" hex head cap screws (K) with slotted washers (J).

14. Use two #10-24 x 1/4" Phillips pan machine screws (D) to secure each pair of two wall brackets (C) together. (See Figure 6)

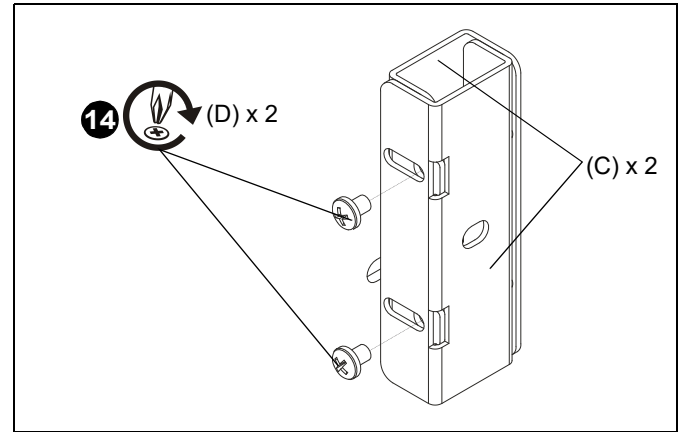

Figure 6

15. Slide two assembled wall brackets behind cross bracket on each end. (See Figure 7)

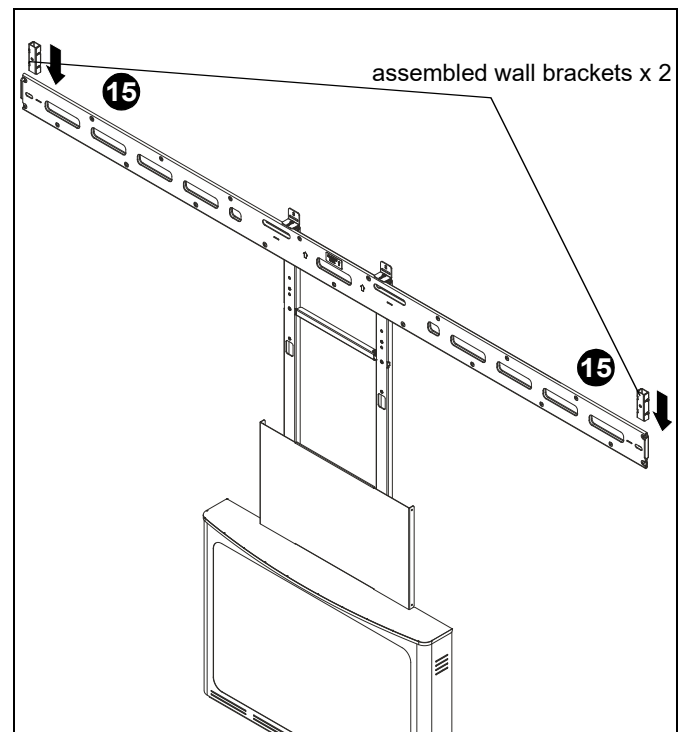

Figure 7

16. (Drywall/steel stud only) Use two 1/4-20 x 2 1/2" Phillips pan head machine screws (F) and two 1/4" washers (G) to secure cross bracket (A) and assembled wall brackets (C) to wall. (See Figure 8)

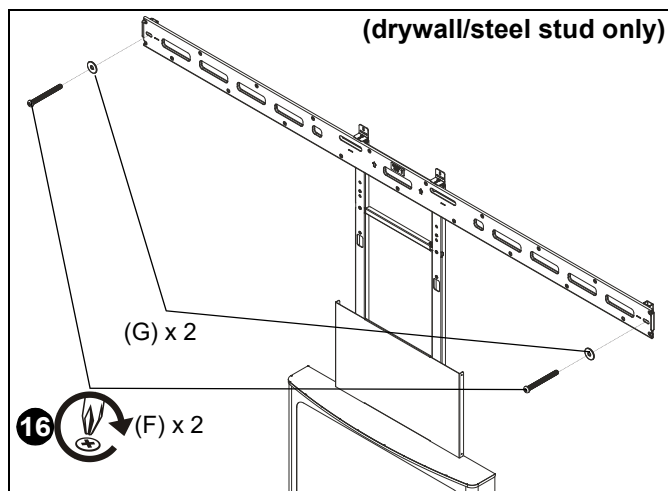

Figure 8

17. (Wood stud/concrete only) Use two 1/4-20 x 2 1/2" hex head cap screws (E) and two 1/4" washers (G) to secure cross bracket (A) and wall brackets (C) to wall. (See Figure 9)

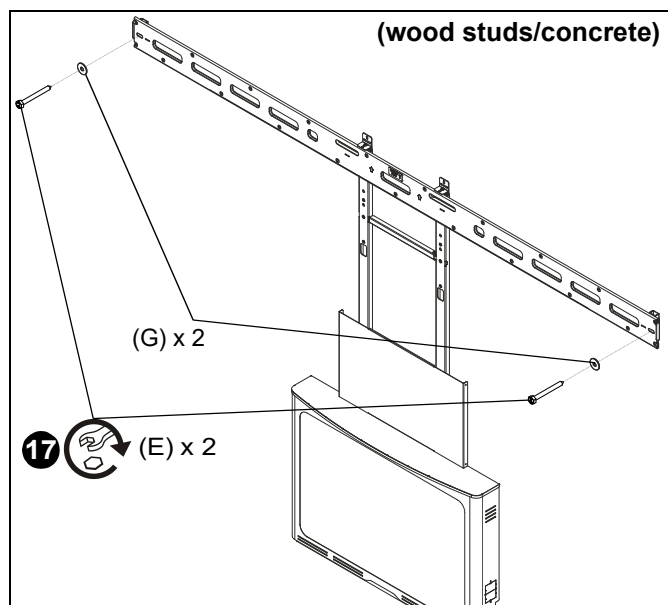

Figure 9

## Displays Installation



**WARNING:** Exceeding the weight capacity can result in serious personal injury or damage to equipment! It is the installer's responsibility to make sure the combined weight of all components and accessories attached to each side of the AVA1104 accessory cross bracket does not exceed 100 lbs (45.3 kg) per display.

1. Align the center of the interface brackets (L and M) with center of screen. (See Figure 11)

**NOTE:** The diamond-shape holes in the bracket correspond to the center of the display.

2. Select correct screws, nesting spacers (if necessary) and universal washers (if required) from the hardware bag (NA~NL) and attach interface brackets (L and M) to back of screens. (See Figure 11)

**IMPORTANT ! :** The M8 screws do **NOT** require a washer. Use the universal washer (NMB) only with M4, M5 and M6 screws.

**NOTE:** The nesting spacers (NMA) may be used separately, or put two together in different configurations to create different size spacers. (See Figure 10)

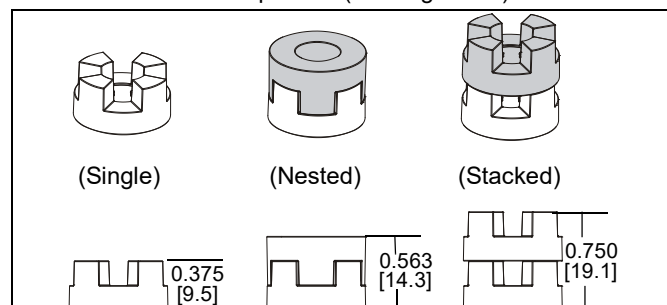

Figure 10

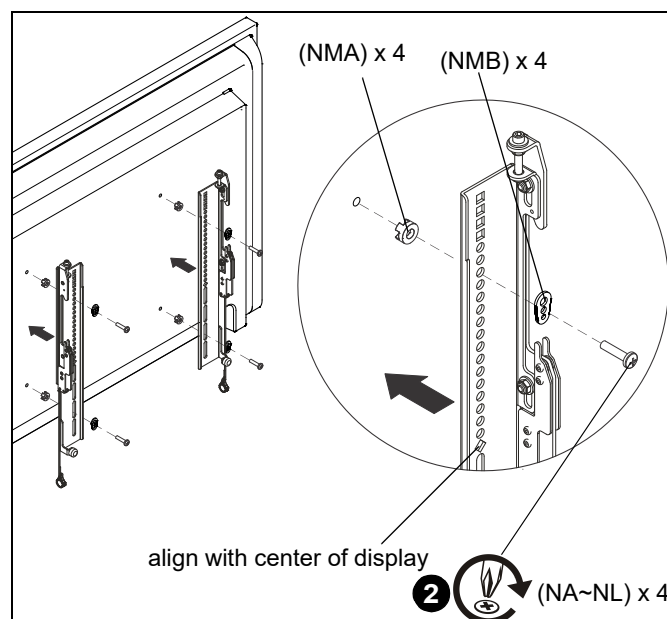

Figure 11

3. Repeat Steps 1-2 for second display.
4. Hang displays on cross bracket (A). (See Figure 12)

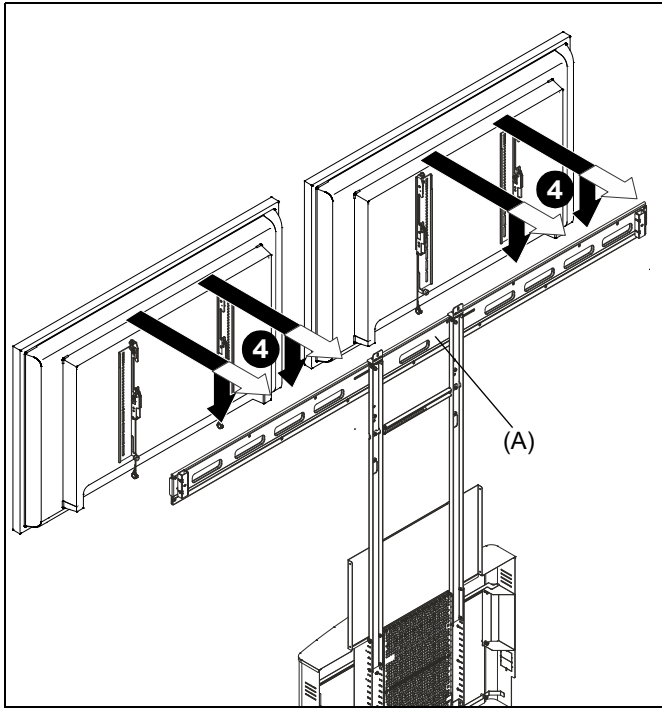

Figure 12

5. Pull down cords on uprights to maneuver lower part of upright under cross bracket (A). (See Figure 13)

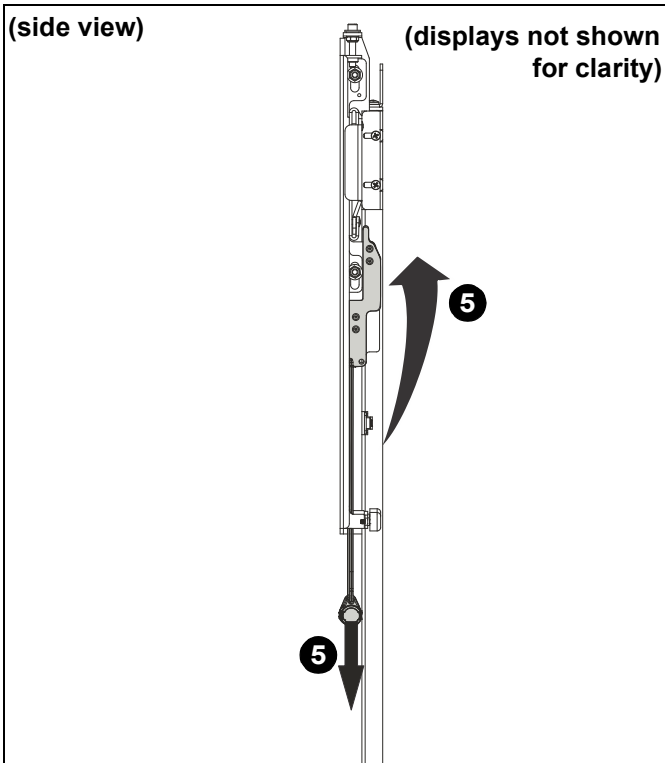

Figure 13

## Adjustments

### Upright height adjustment

1. Use 3/16" x 10" hex key (B) to adjust height of uprights (L and M). (See Figure 14)

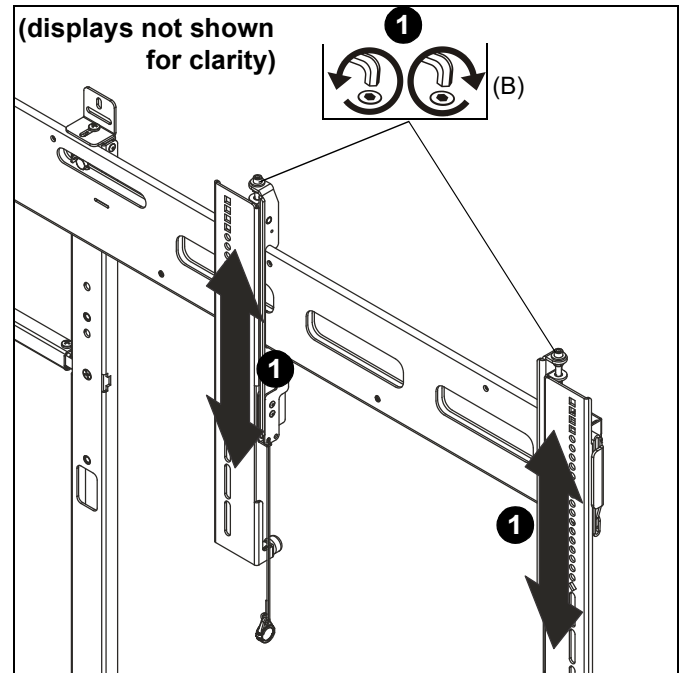

Figure 14

### Stabilizing Buttons

1. Rotate stabilizing buttons to increase or decrease tilt of each upright. (See Figure 15)

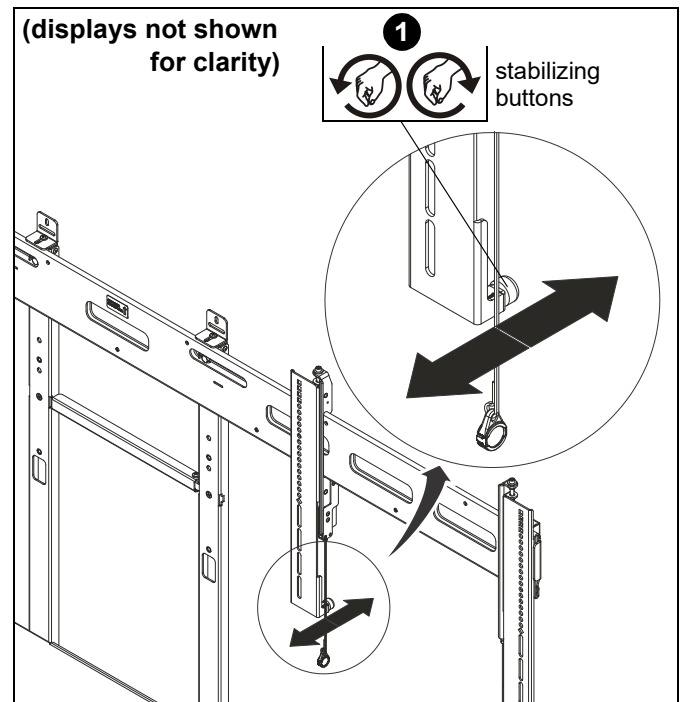
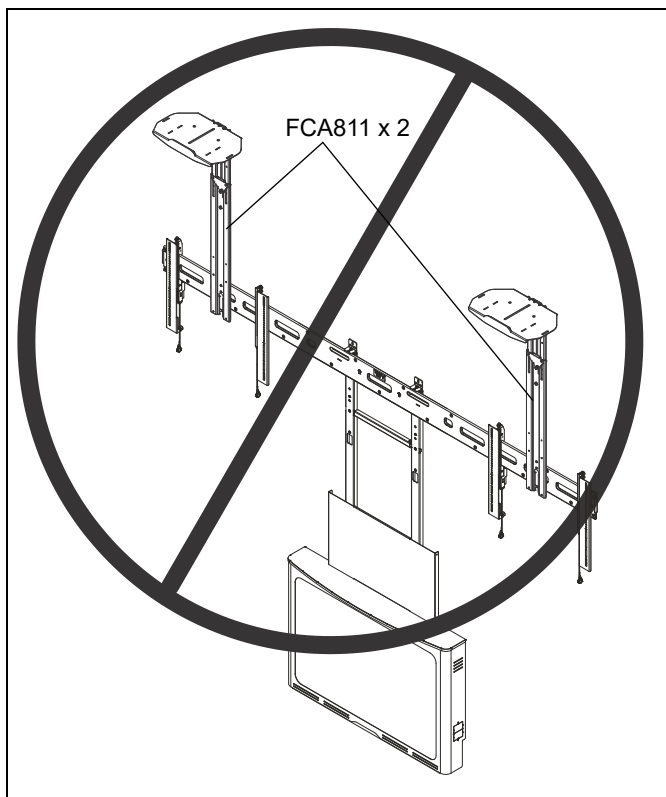

Figure 15

## Shelf Accessory Usage

**IMPORTANT !** : Most Chief camera or accessory shelves can be used with the AVA1104 accessory, above or below each mounted display. However, the FCA811 shelf **CANNOT** be installed **ABOVE** EACH display or it may cause mounting brackets to pull out of the wall. (See Figure 16)



**Figure 16**







8800-003353 Rev00  
©2022 Legrand | AV  
[www.legrandav.com](http://www.legrandav.com)  
03/2022

USA/International	A 6436 City West Parkway, Eden Prairie, MN 55344 P 800.582.6480 / 952.225.6000 F 877.894.6918 / 952.894.6918
Europe	A Franklinstraat 14, 6003 DK Weert, Netherlands P +31 (0) 495 580 852 F +31 (0) 495 580 845
Asia Pacific	A Office No. 918 on 9/F, Shatin Galleria 18-24 Shan Mei Street Fotan, Shatin, Hong Kong P 852 2145 4099 F 852 2145 4477

