

Premium Wall Mount for Sonos Era 300

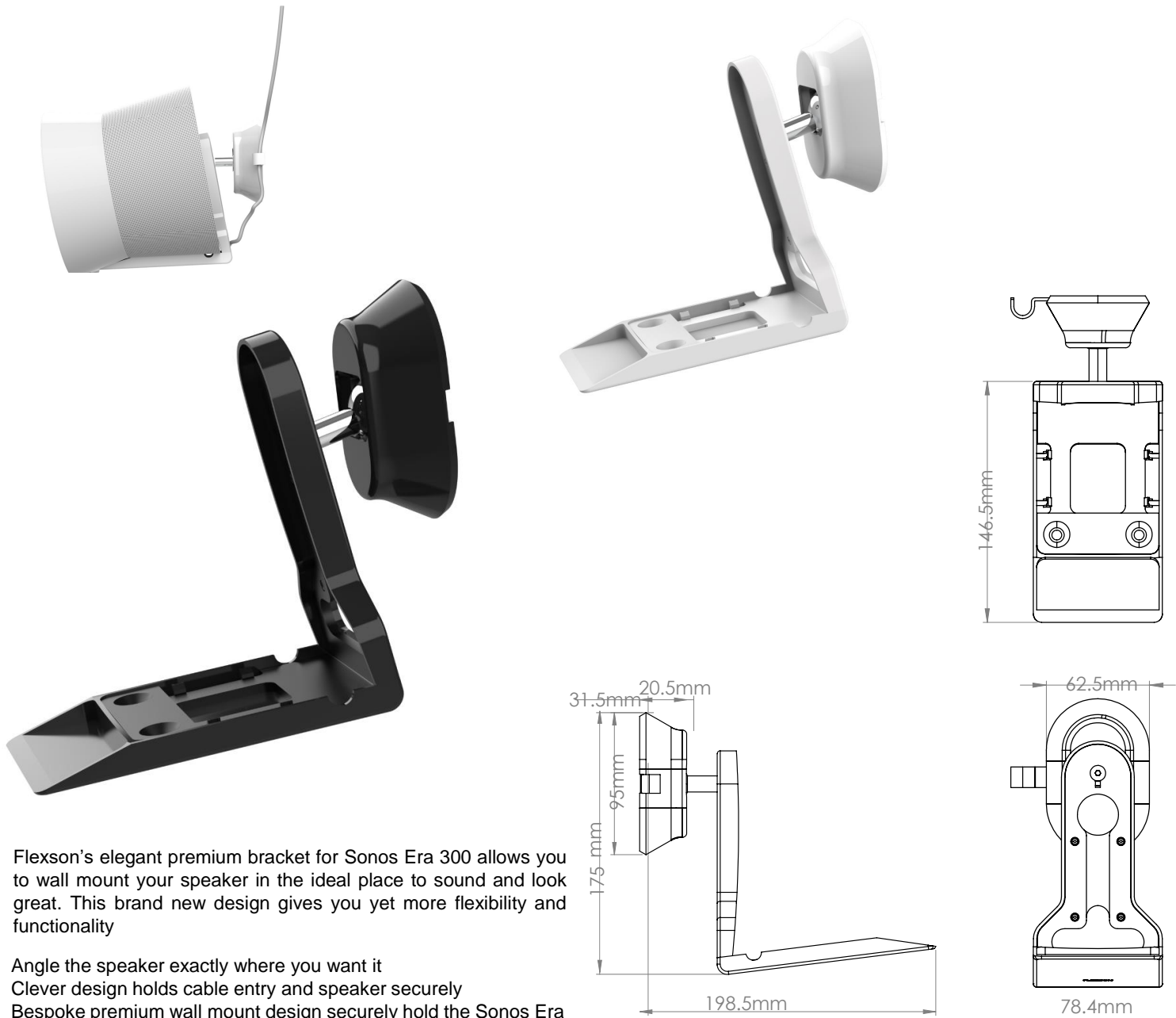

Flexson’s elegant premium bracket for Sonos Era 300 allows you to wall mount your speaker in the ideal place to sound and look great. This brand new design gives you yet more flexibility and functionality

- Angle the speaker exactly where you want it
- Clever design holds cable entry and speaker securely
- Bespoke premium wall mount design securely hold the Sonos Era 300 with a mechanical fixing locking the speaker into position
- Base seamlessly fits the speaker, holding it securely wherever you want to wall mount it
- Can be inverted to securely hold the speaker upside down - so its controls (and the Sonos Era 300 touch and voice controls) are easily accessible if mounting higher up the wall
- Has a unique tilting mechanism up to 88 degrees (49 degrees upwards and 39 degrees downward or vice versa) plus can swivel up to 106 degrees (53 degrees left and 53 degrees right)
- Precision engineered
- Quick and easy to fit
- High grade-steel and plastic construction
- Available in black or white to perfectly match the Sonos Era 300
- Fixing hardware included for Brick/Masonry and Wood/Studwork
- Designed and engineered in the UK

| | White | | Black | |
|---------------------------|--|-----------------------|----------------|---------|
| Product Code | FLXE300PWM1011 | | FLXE300PWM1021 | |
| UPC Number | 5057964003221 | | 5057964003238 | |
| UK, European and US (SRP) | £89.99 | | € 99.99 | \$99.99 |
| Product Specifications | Height | Width | Depth | Weight |
| Product Size (mm) | 175mm | 78.4mm | 198.5mm | 0.69KG |
| Carton Dimensions (mm) | 222mm | 143mm | 65mm | 0.75KG |
| Carton Contents | 1 x Premium mount 1 x instructions 1 x fixings | | | |
| Country of Manufacture | China | Outer Carton Quantity | | 10 |

Marketing assets:

Exertis (UK) Ltd, St George House, Parkway Harlow Business Park, Harlow, Essex CM19 5QF UK