



**THE GRAND**  
**मराठा**  
*Comfortable Living*  
 SARTHAK SINGAPORE GROUP



**Singapore**  
 SARTHAK SINGAPORE GROUP



**20 YEARS • 20,000+ SMILES**



## **ABOUT THE GROUP**

- Inception: 2001
- Number of projects: **32+**
- Area of developed land: **6.8 million sq. ft.**
- More than **5000 investors & users** are committed to the group
- **200+ realtor** working under one umbrellalla
- **Credai** member
- **RERA** approved projects.



## **A.B. ROAD**

- Agra-Bombay National Highway – 3 (100 ft road)
- Super Markets like Metro & Best Price in Vicinity
- 10 Minutes away from Vijay Nagar Sq.
- Super Speciality Hospitals like Bombay Hospital, Medanta and Apollo in Surroundings Adjacent to One of the Biggest Educational Institutes
- Lush Green & Serene Ambience
- Best Connectivity for Every Corner of The City
- 30 Minute Away from the Heart of the City Rajwada
- 10 mins from Indore bypass
- Adequately populated area.

# शहर के नजदीक शानदार आवासीय परियोजना



**The Grand Maratha is a luxurious premium residential plotting project of Sarthak Singapore Group based in Talawali Chanda, AB Road, Indore.**





## **FACILITIES:**

- 24x7 Security
  - Entry Gate
  - Garden
  - Concrete Road
  - Good Water Supply
  - Secured Campus
- 
- Swimming Pool,  
Gym, Club House  
(in our personal club)





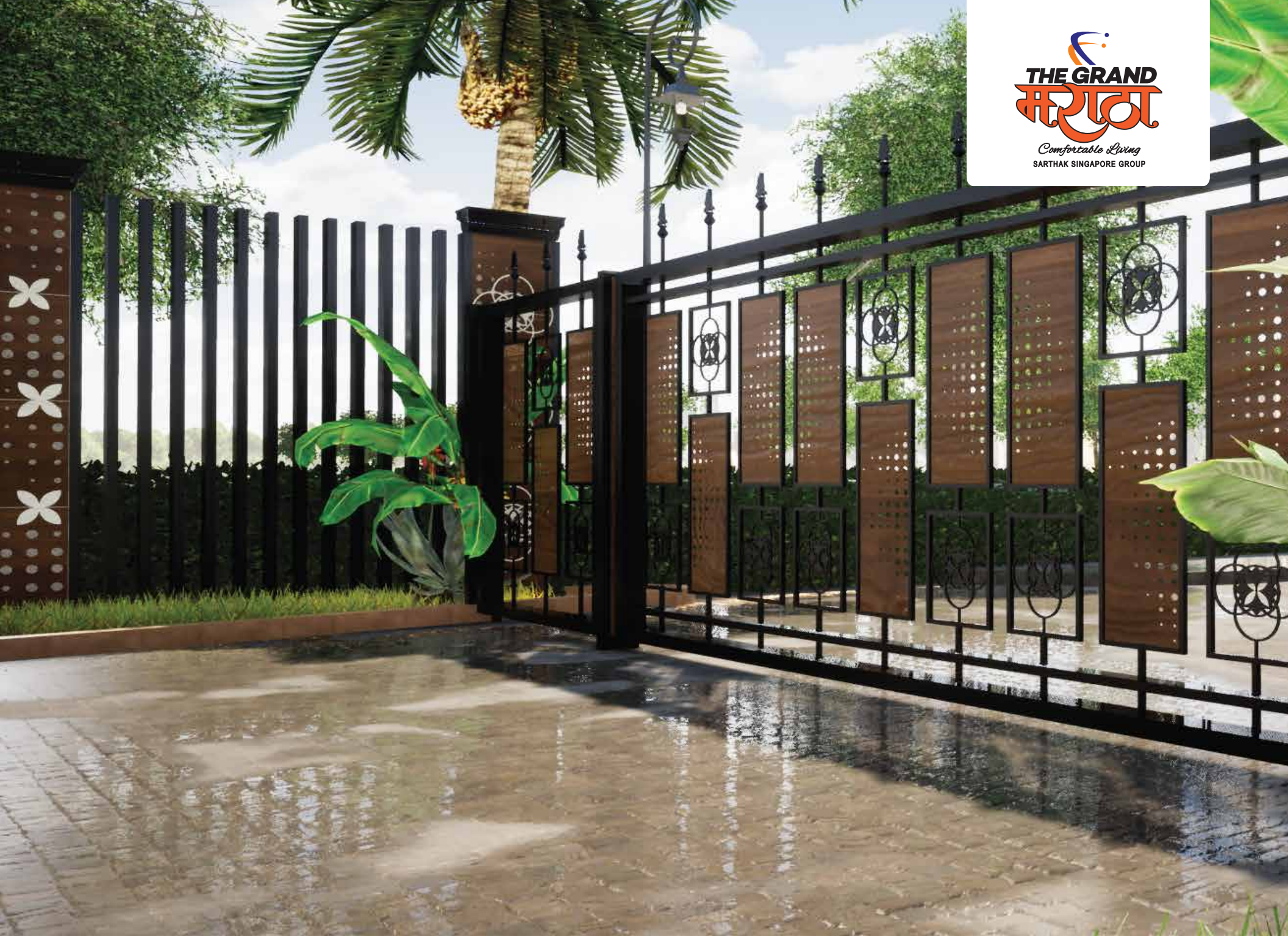







# FULLY-PLANNED STRUCTURE

- In the memory of Late Sukhdev Marathe.
- 6 acres of covered campus.
- Unit size - 600, 800, 1200 sq.ft.
- 8km from Vijay Nagar square, more than 6 unique styled community gardens.

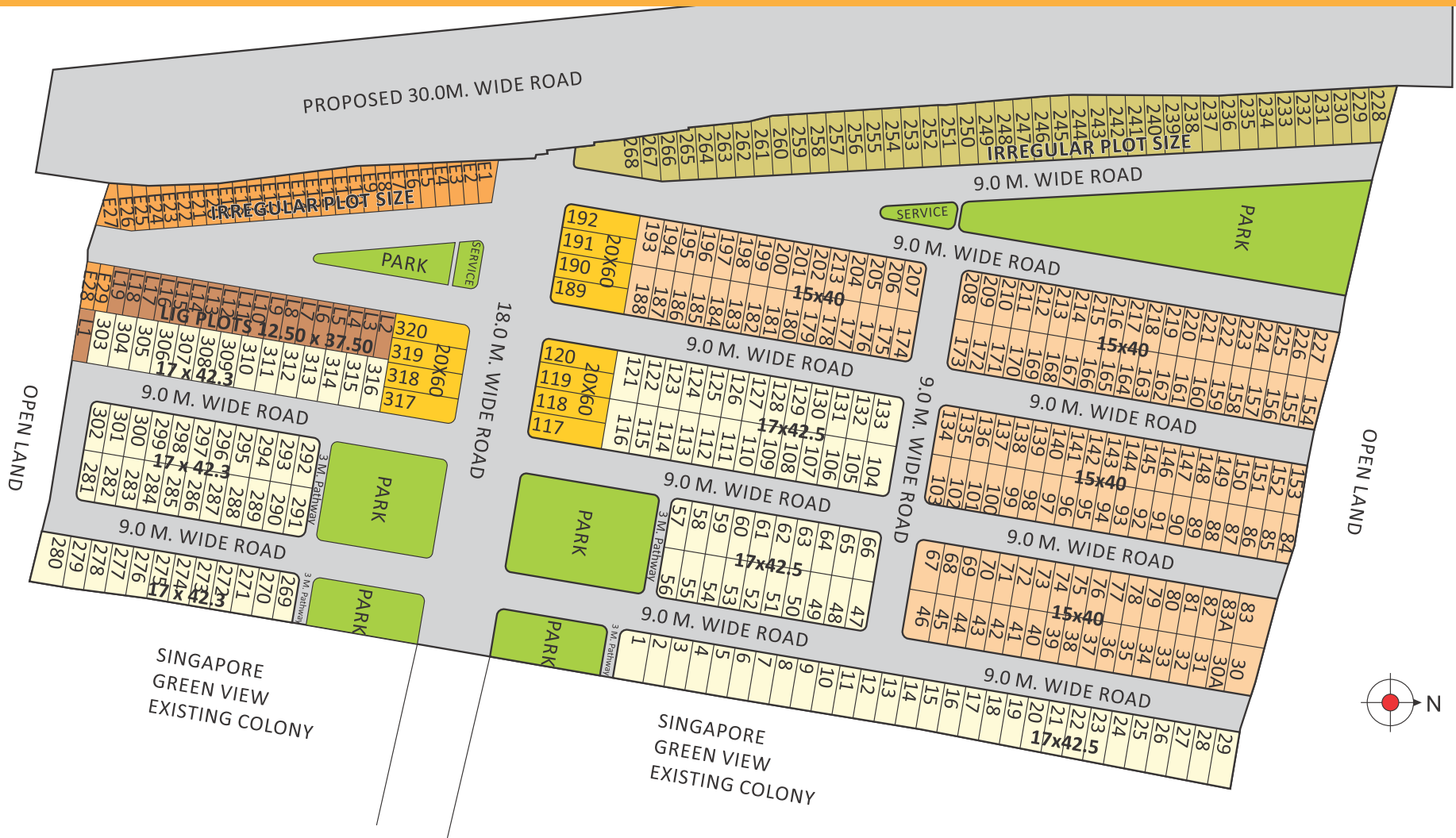

# " THE GRAND MARATHA "

OPEN LAND

valid up to 30/12/22  
 APPROVED  
 As Per Condition of Sale  
 Memo No. 12162

*John Director*  
 Town & Country Planner  
 No. 1547

*Arundhan*  
 Town & Country Planner  
 No. 1547

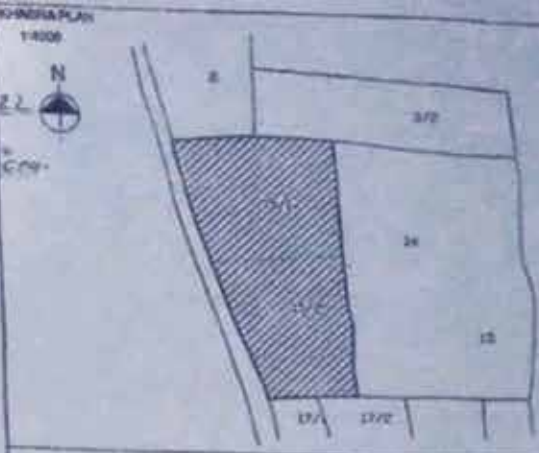

PROPOSED LAY-OUT PLAN FOR PLOTTED RESIDENTIAL USE ON  
 KHASRA NO. 191.193  
 AT VILLAGE - TALAMBU CHANDA DIST. - MOORE

S.No	AREA IN SQ. METERS	AREA IN HA AS PER MEASUREMENT	PERCENTAGE
1	7.79	2.88	100%
2	2.24	2.82	100%

### AREA STATEMENT

* TOTAL LAID AREA (AS PER RECORD)	= 44720 SQM.
* AREA AVAILABLE AS PER MEASUREMENT	= 41940 SQM.
* AREA UNDER 15.0M. ROAD	= 2230 SQM. 100%
* NET AREA - PLANNING	= 38810 SQM. 100%
* PARK AREA	= 3881 SQM. 10.00%
* SERVICE AREA	= 300 SQM. 1.00%
* PLOT AREA	= 20175 SQM. 51.98%
* EWS PLOT AREA	= 1070 SQM. 2.78%
* LG PLOT AREA	= 890 SQM. 2.18%
* ROAD & PATHWAY AREA	= 12444 SQM. 32.06%

### EWS AREA & LG AREA CALCULATION

TOTAL NO. OF PLOTS	= 225 NO.
EWS & LG PLOTS @ 1% OF NO. OF PLOTS	= 48 NO.
EWS PLOTS @ 3% OF 48 NO.	= 23 NO.
LG PLOTS @ 4% OF 48 NO.	= 19 NO.

SCALE	DEVELOPER'S SIGN	ARCHITECT PLANNER
SCALE: 1:1000		



Signature valid  
 Digitally signed by *VIKANT*  
 MOGAL  
 Date: 2019.12.31 19:37:29 IST

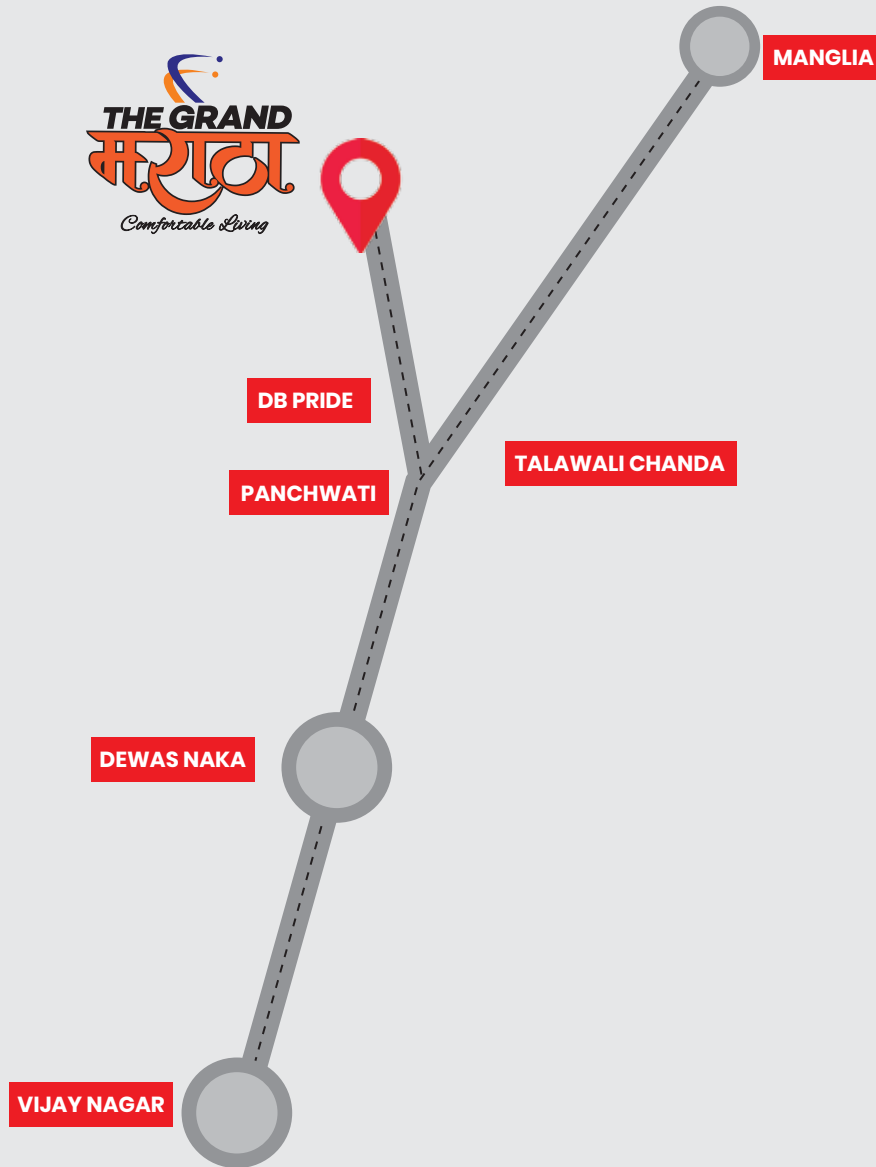

**NEAREST  
TO PRIME  
LOCATIONS  
OF INDORE.  
10 MINUTE  
FROM  
VIJAY  
NAGAR.**

